

ColorlightCloud

User Manual v1.1

Content

1	Quick Start	1
1.1	Step 1: Register & Sign in ColorlightCloud.....	1
1.2	Step 2: Add Terminals to ColorlightCloud	2
1.3	Step 3: Publish Program to Terminals.....	3
2	Control Terminal Group & Terminal.....	5
2.1	Control Terminal Group	5
2.2	Control Terminal.....	7
3	Publish Schedule.....	11
3.1	Publish Program Schedule	11
3.2	Publish Command Schedule	12
3.3	Delete Schedule.....	14
4	Manage media	15
4.1	Upload media	15
4.2	Delete media	16
4.3	Add Tag.....	17
4.4	Share.....	18
4.5	Preview media	19
4.6	Create File Playlist	19
4.7	View media details.....	20
4.8	Search media	20
4.9	Manage media folders.....	22
5	Manage Program	23
5.1	Search Program	23
5.2	Create Program Schedule.....	23
5.3	Preview Program	23
5.4	Publish Program.....	23
5.5	Update Program	24
5.6	Delete Program.....	24
5.7	View program details.....	25
5.8	Review Programs.....	25
6	Create Programs.....	25

6.1 Edit Playlist Name.....	26
6.2 Edit Playlist Width and Height.....	26
6.3 Edit Playlist windows	26
6.4 Edit Playlsit Page	27
6.5 Preview Program	28
6.6 Save Program.....	28
6.7 Load Templates	28
7 Monitor Terminal.....	28
8 View terminal statistics	31
8.1 View media playing times.....	31
8.2 View online time	31
8.3 View Switching Times.....	32
9 View terminal map	33
9.1 View terminal coordinates.....	33
9.2 View terminal traces.....	34
9.3 View Heat map	34
10 View Operation log.....	36
10.1 View terminal operation log	36
10.2 View terminal log.....	36
10.3 View content management log	37
11 Manage accounts.....	37
11.1 View account statistics.....	37
11.2 Reset Password.....	38
11.3 Login Authentication.....	39
11.4 Switch language and theme.....	39
11.5 Manage users	40
11.6 System Settings	41
11.7 View ColorlightCloud version	42
Statement.....	43

1 Quick Start

The user manual mainly describes administrator operations on ColorlightCloud. The administrator has the authority to perform all operations.

1.1 Step 1: Register & Sign in ColorlightCloud

1. Submit an application for ColorlightCloud account registration to relevant person in charge of Colorlight and provide username and email.
2. Enter the ColorlightCloud server URL to enter the login interface.
 - Recommend: Google Chrome browser.

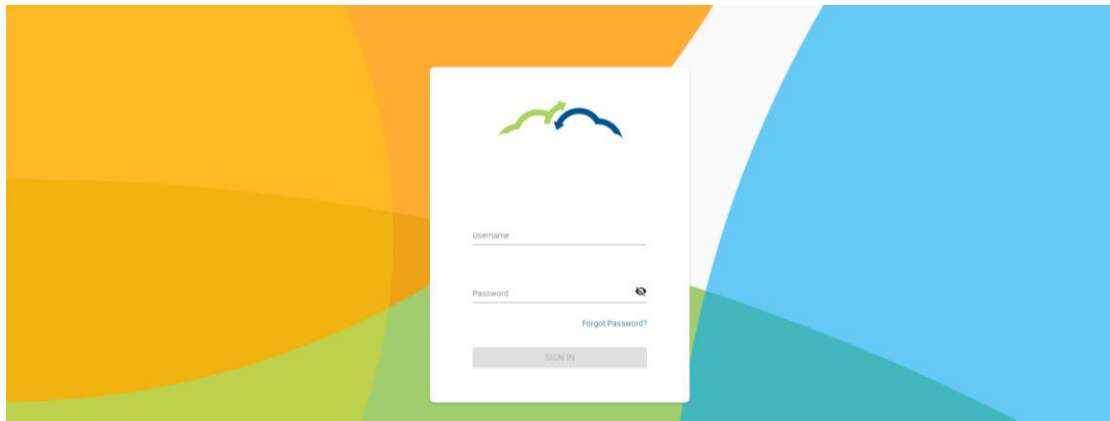

Figure 1-1 Sign in interface

3. Enter the Username and password, click **Sign in**, enter the ColorlightCloud main interface.
 - If you enter the wrong account number or password up to 5 times, your account will be blocked.

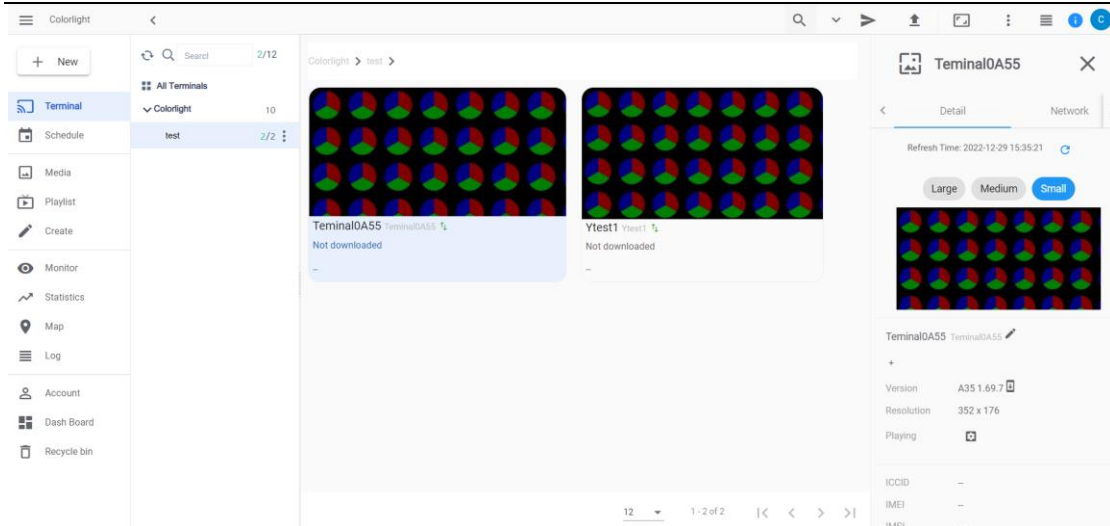

Figure 1-2 ColorlightCloud main interface

1.2 Step 2: Add Terminals to ColorlightCloud

If you want to control terminal, please add terminal to ColorlightCloud, this step requires PlayerMaster software.

Steps:

1. Download and install PlayerMaster installation package in Colorlight website.
 - Please refer to the "Installation and Uninstallation" section of PlayerMaster User Manual for the installation.
2. After successful installation, open the software and select cloud mode.
3. Use USB cable to connect the terminal to computer.

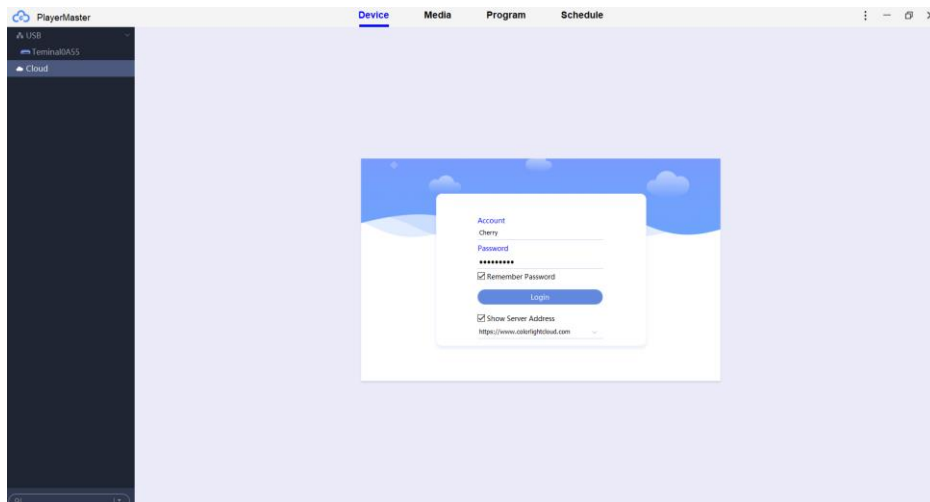

Figure 1-3 PlayMaster Login interface of Cloud mode

4. In the PlayerMaster cloud mode login interface, enter your ColorlightCloud account, password and Server Address, click **Login**.
5. After login successfully, under the terminal tree on the left side of the PlayerMaster interface, hold down mouse and drag the USB directly connected terminal to the cloud terminal group.
 - Make sure the terminal network is normal.
 - If the terminal is displayed under the cloud terminal tree and is online, and data loading is completed, the terminal is successfully bound to ColorlightCloud.
6. Return to ColorlightCloud.

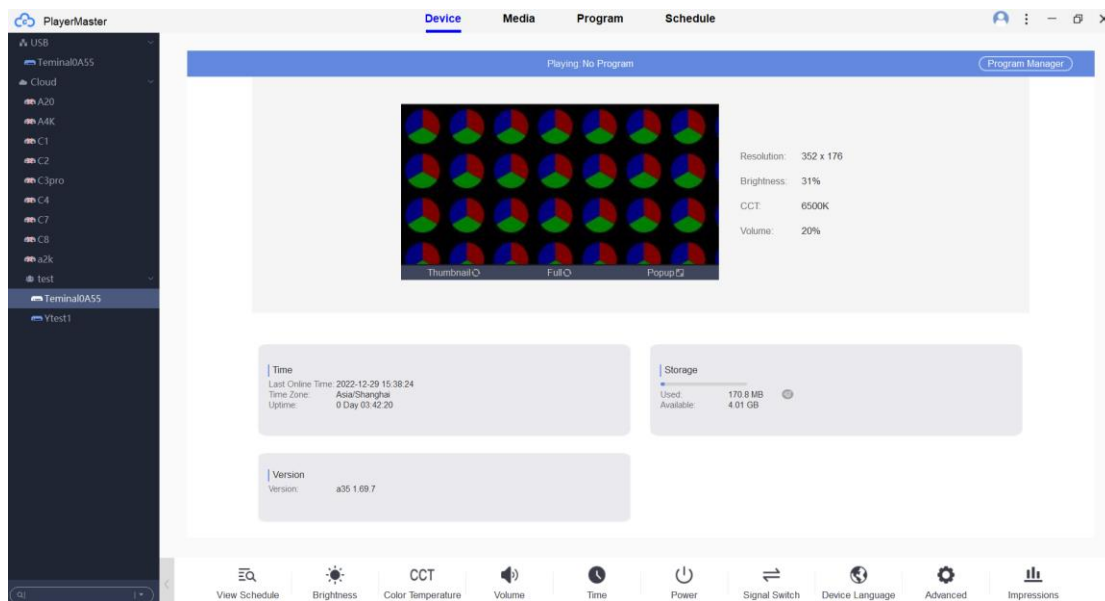

Figure 1-4 Terminal is bound successfully

1.3 Step 3: Publish Program to Terminals

1. Select "Media", click **Upload** to upload material from your local file.
2. Select "Edit Program" to enter the program name and resolution at the top of the interface.
3. Drag and drop media from the left side of the interface to the green box at the bottom of the interface to create a file window program.
 - You can also add different program windows by clicking the program window icon at the top of the interface or the add icon **+** at the bottom left of the program preview window.
4. After editing program, click **Save** in the upper right corner of the interface to save the program.

4. Select "Program" module, choose a normal or an approved program, click the publish icon ➤ at the top right of the interface.
5. In the pop-up publishing window, select the terminal group and terminal you want to publish and click **Confirm**.

When publish successfully, the bottom of the interface will indicate "Publish Successful".

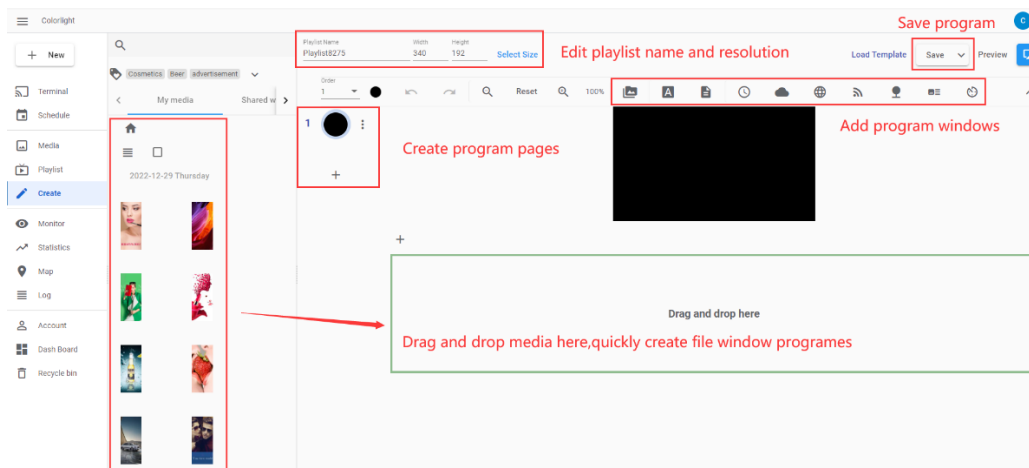

Above is the basic operation about ColorlightCloud, if you want to know more detailed operations related to each function module, please read along.

2 Control Terminal Group & Terminal

To control Terminal Group and Terminal in the ColorlightCloud "Terminal" module.

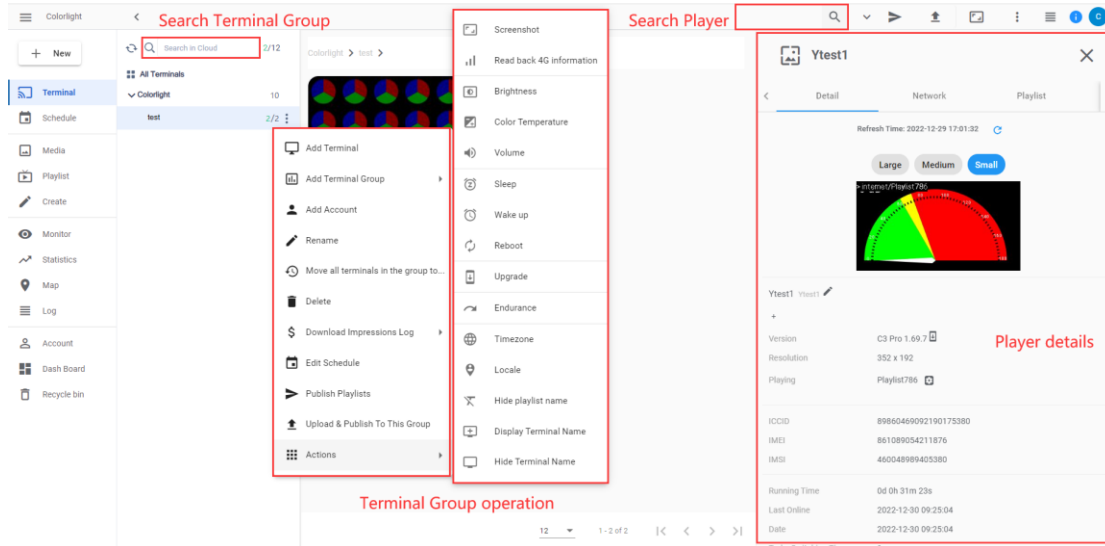
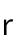

Figure 2-1 Terminal Interface

2.1 Control Terminal Group

Click  in the upper right corner of the terminal group name to perform the following operations:

- **Add terminal:** Add terminals under this terminal group.
- **Add terminal group:** Add a general or final terminal group to this terminal group.
 - Administrators under the general terminal group can manage subordinate users. Subordinate users of administrators are non-administrative users and all users in sub-terminal groups within the unified terminal group alongside administrators.
 - If you want to create a user who only uses ColorlightCloud and that user does not need to manage other users, you can create final terminal group and then add end users. Sub-terminal groups can be created under the final terminal group. Sub-terminal groups can add terminals but not users.
- **Add Account:** Register subordinate users to this terminal group and the optional roles are Administrator, Operator, Playlist Editor, Invitee, Auditor, Monitor, advertiser, Statistician, and assembler.
- **Rename:** Rename this terminal group, the root terminal group cannot be

renamed.

- **Move the terminals used in this group to other groups:** Move all the terminals in this group to other terminal groups.
- **Delete:** Deletes the mobile device group. You cannot delete a mobile device group when there are mobile devices, sub-terminal groups, or users belonging to the group.
- **Download playlist logs:** Downloads the playlist logs of the mobile devices under this terminal group.
- **Edit schedule:** Edit terminal group schedule.
- **Publish programs:** Select programs to publish to this terminal group.
- **Upload and publish to this group:** Upload local media, automatically save them as programs and publish them to the terminal group.

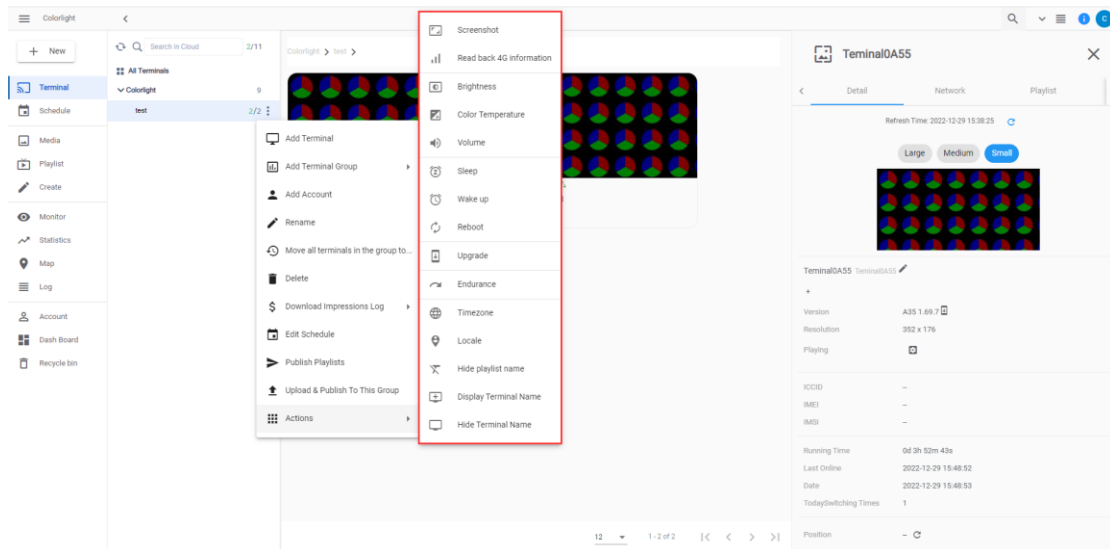

Figure 2-2 All Terminals operations under terminal group

- **Operations:**
 - **Screenshot:** Refresh all screenshots under this terminal group.
 - **Read back 4G information:** Read back the device IDs and SIM card IDs of the terminals in this terminal group whose network mode is 4G, in statistics module, check 4G information in the online statistics.
 - **Brightness:** Adjusts all terminals display brightness in the terminal group.
 - **Color Temperature:** Adjusts all terminals display color temperature in the terminal group.

- **Volume:** Adjusts all devices playback volume in the terminal group.
- **Sleep:** Turns off all devices screen in the terminal group.
- **Wake up:** Brightens all terminals screens in this terminal group.
- **Reboot:** Reboot all devices in the terminal group.
- **Upgrade:** Upgrades all devices in the terminal group. To upgrade successfully, the upgrade package must match the terminal model and be higher than the existing terminal version.
- **Timezone:** Modifies all devices time zone in the terminal group.
- **Locale:** Modifies all devices language in the device group.

2.2 Control Terminal

Double-click terminal to enter Detail interface, as shown in Figure 2-3.

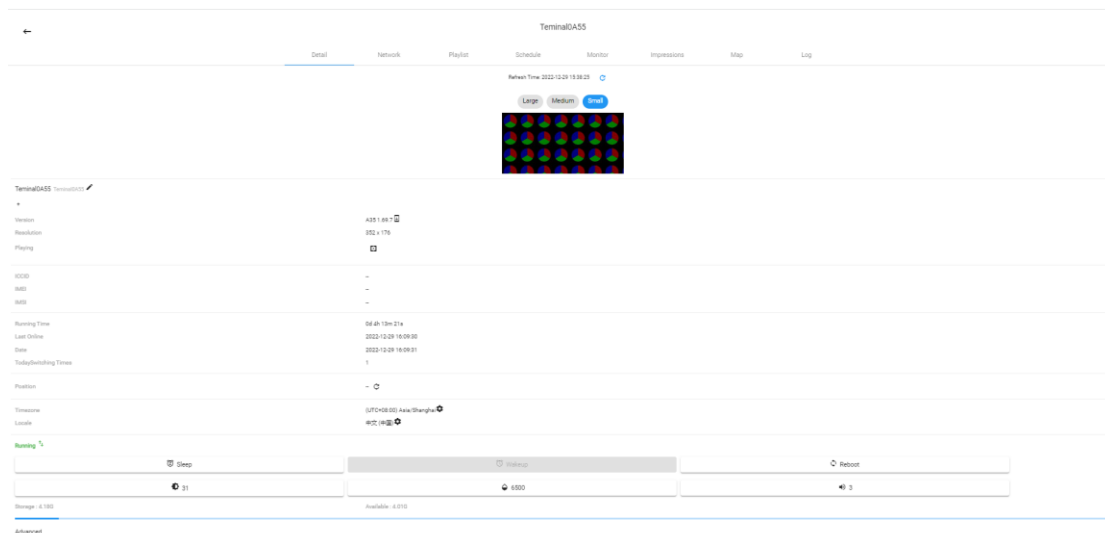

Figure 2-3 Terminal details interface

In the "Details" interface (Figure 2-3), you can refresh terminals screenshot, crop screenshot size, upgrade terminal, check terminal online time, modify terminal time zone and locale, switch terminal signal, hibernate, wake up and reboot terminal, adjust the brightness, color temperature and volume, check terminal storage, rotate screen and switch data sources.

- Only A100, A200, C6, C7 and C8 can be switched asynchronously in the "details" interface of ColorlightCloud.

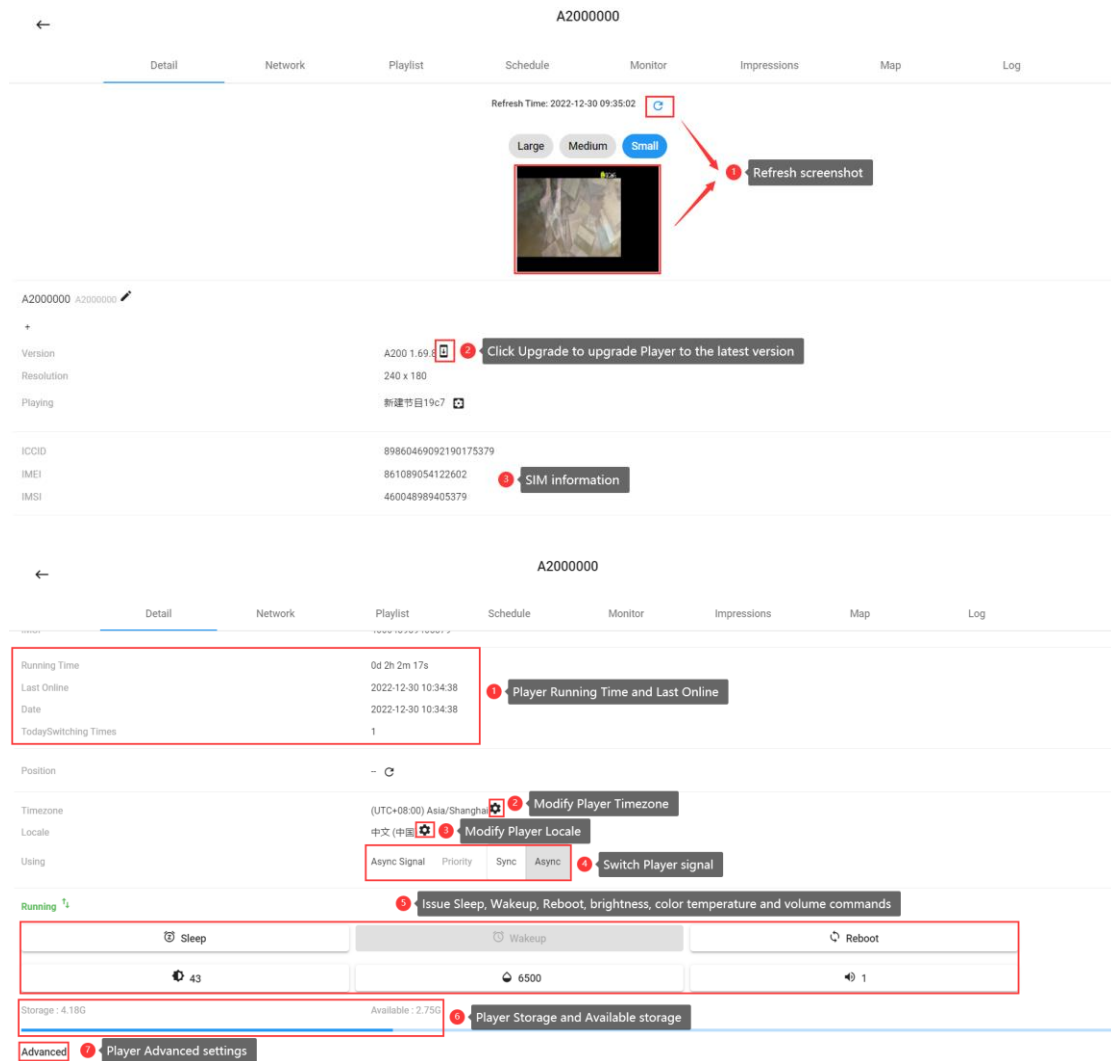

Figure 2-4 Detail Interface

In the "Network" interface, you can view the network connection mode of the terminal (WiFi, cable, 4G).

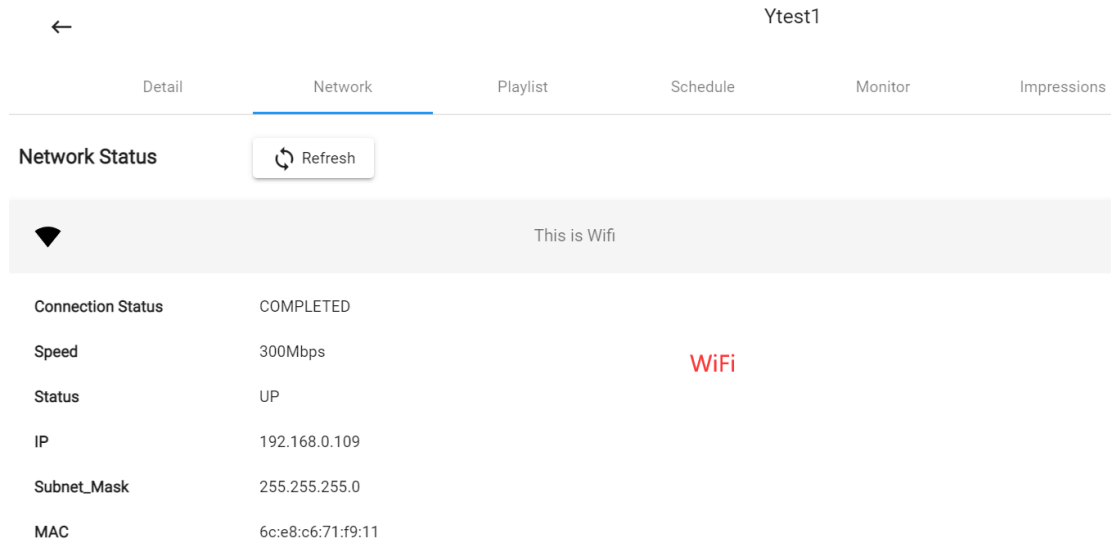

Figure 2-5 WiFi connection interface

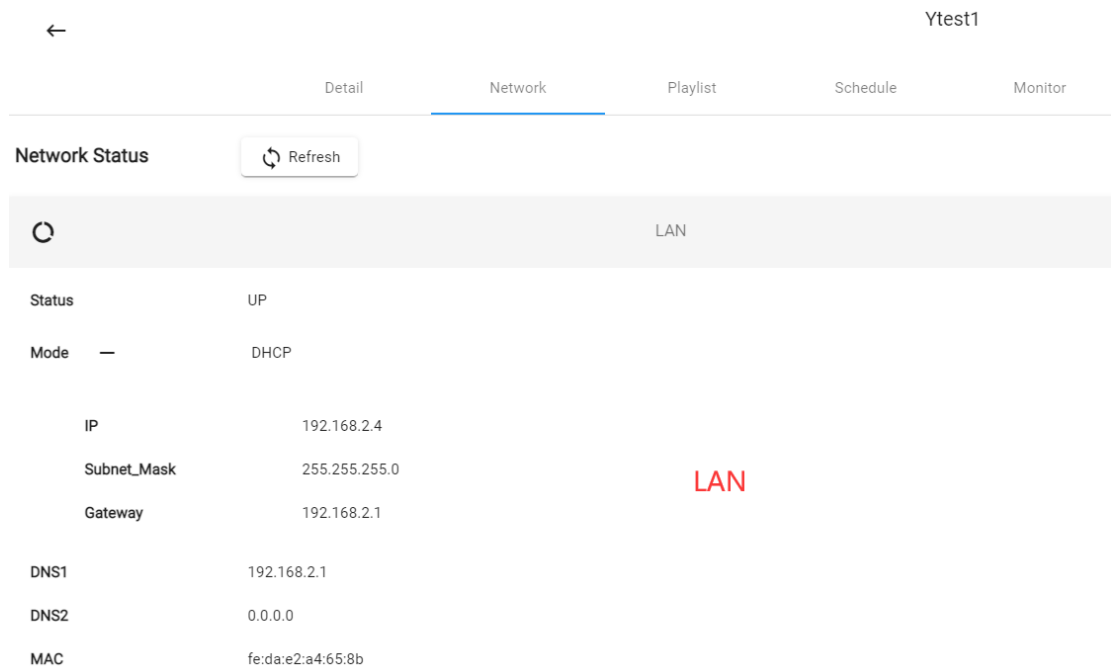

Figure 2-6 LAN connection interface

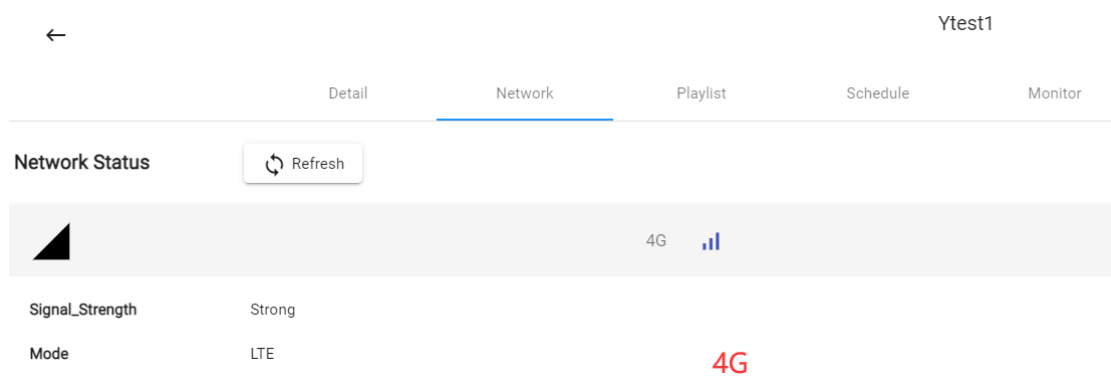
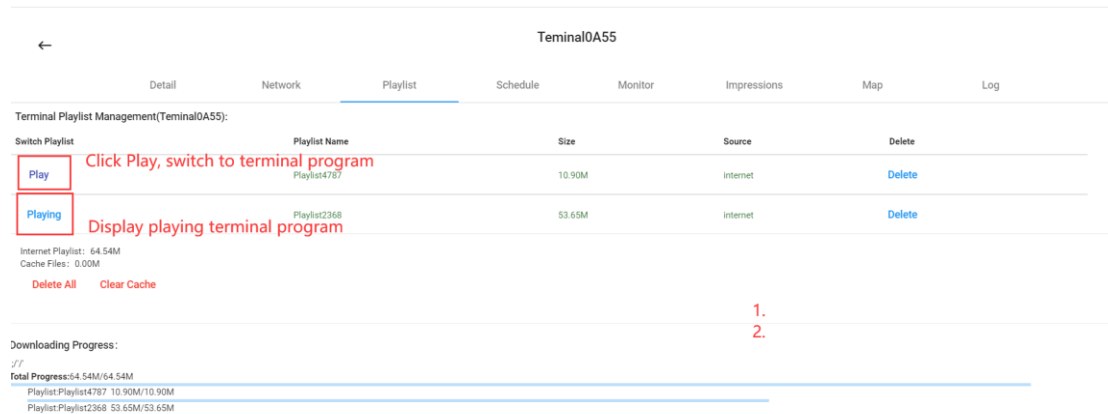

Figure 2-7 4G connection interface

On the "Content" interface (Figure 2-9), you can view the program list of the terminal and switch the program being played.



Terminal0A55

←

Detail Network **Playlist** Schedule Monitor Impressions Map Log

Terminal Playlist Management(Terminal0A55):

Switch Playlist

	Playlist Name	Size	Source	Delete
Play	Playlist4787	10.90M	Internet	Delete
Playing	Playlist2368	53.65M	Internet	Delete

Internet Playlist: 64.54M
Cache Files: 0.00M

Delete All Clear Cache

1.
2.

Downloading Progress:

Total Progress: 64.54M/64.54M

Playlist: Playlist4787 10.90M/10.90M

Playlist: Playlist2368 53.65M/53.65M

Figure 2-8 Terminal Playlist Interface

To view and set up scheduling, monitoring, playback statistics, maps and logs of terminal. For detailed operation, please refer to the instruction of each function module.

3 Publish Schedule

In the "Schedule" module, set program scheduling and command scheduling, i.e. set a terminal group to play a specific program at a specific time, or execute commands such as sleep or wake up.

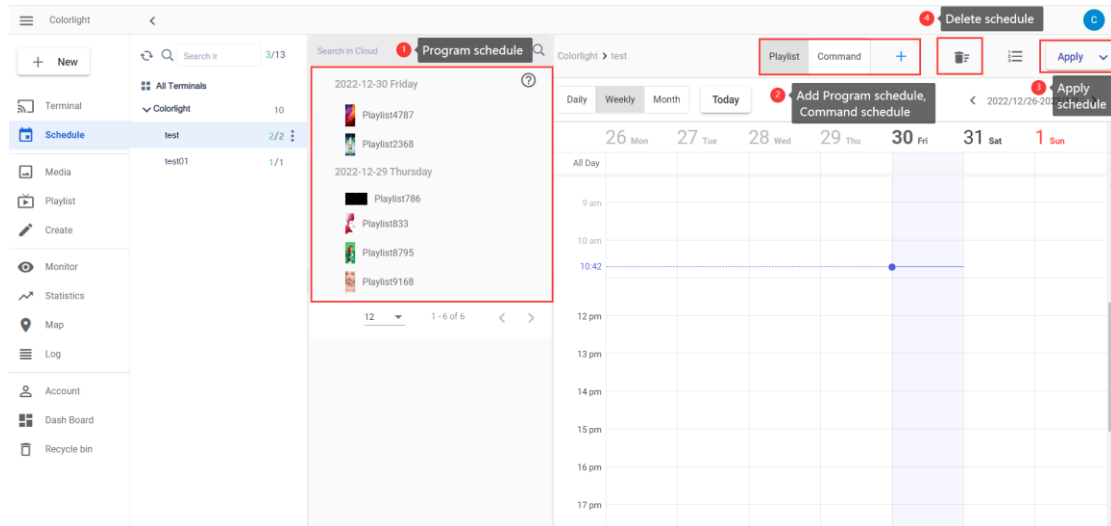

Figure 3-1 Schedule main interface

3.1 Publish Program Schedule

1. Add Program Schedule.

There are two ways:

- Drag programs from the program list on the left to schedule area on the right.
- Click **+** in the upper right corner of the interface.

The following window pops up:

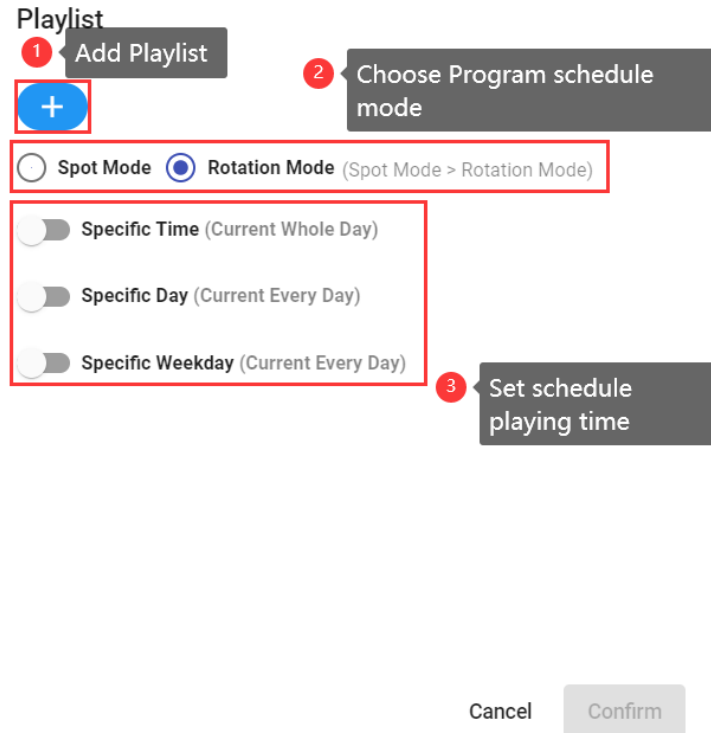

Figure 3-2 Program schedule setting interface

2. Select Program Schedule Type.

- There are 2 types of program schedule: Spot Mode and Rotation Mode.
- Spot Mode take precedence over Rotation Mode. If there is an overlap between the time of Spot Mode and Rotation Mode, the Rotation program will be played first during the execution time of those programs.
- If multiple rotating programs have overlapping times, they will be rotated and cycled in order of priority during the execution time of those programs.
- If multiple spot programs have overlapping times, only the program with the highest priority will be played during the execution time of those programs.

3. Set program playing time.

- Program schedule can specify time, day and week. The effective time for program playback is the concatenation of setting time, date and week.

4. Click confirm.

5. Click **Apply** in the upper right corner of the interface.

- You can select to apply the schedule to this terminal group or all sub-terminal groups in this terminal group.

3.2 Publish Command Schedule

1. Click **Command Schedule** and **+** on the upper right corner of the

interface.

The following window pops up:

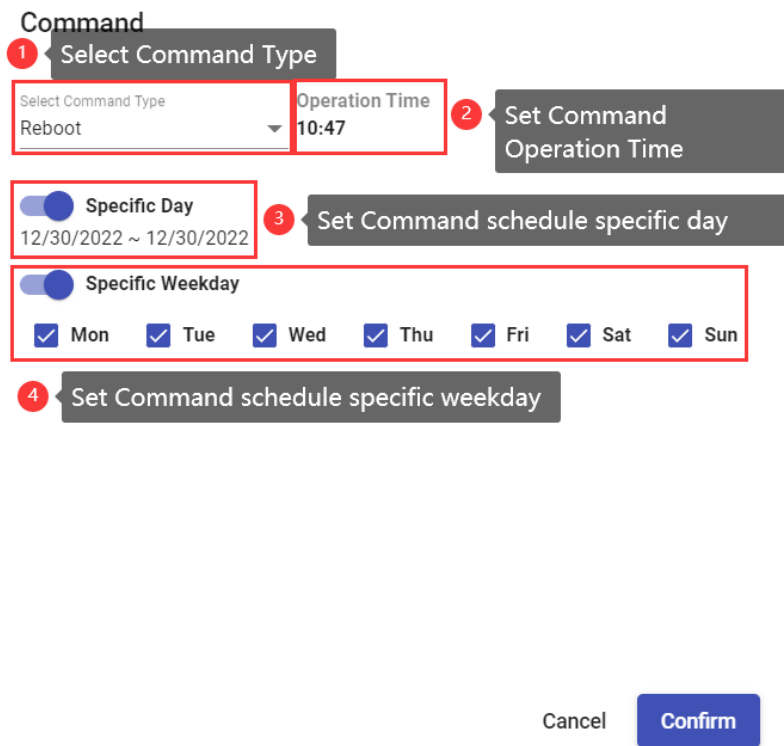

Command

1 Select Command Type

Select Command Type
Reboot

Operation Time
10:47

2 Set Command Operation Time

3 Set Command schedule specific day

Specific Day
12/30/2022 ~ 12/30/2022

Specific Weekday

Mon Tue Wed Thu Fri Sat Sun

4 Set Command schedule specific weekday

Cancel **Confirm**

Figure 3-3 Set up Command schedule interface

2. Select the command type.

- The command types include restart, hibernate, wake up, brightness control, color temperature control, volume control, clear cache, switch source, relay on, and relay off.
- The "switch source" command is applicable to A100, A200, C6, C7 and C8 terminals under the cloud.
- The "Relay On" and "Relay Off" commands apply to terminals connected to M2.
- The restart command is a moment value and the rest of the commands are status values. Therefore, except for the restart command, all commands need to be set in pairs. For example, the hibernation and wake-up commands need to be set together, and the brightness control command needs to be set at least two times for brightness control.



3. Set the instruction execution time.

- Command scheduling can set the execution time, specified date and specified day of the week. The valid time for the terminal to execute the command is the set of three values of execution time, specified date, and specified day of the week.

4. Click **Confirm**.
5. Click **Apply** in the upper right corner of the interface.
 - You can select to apply the schedule to this terminal group or to all sub-terminal groups under this terminal group.

3.3 Delete Schedule

You can delete individual schedules or all schedules. Please note that after adding, updating or deleting a schedule, you need to click **Apply** before the terminal will apply the settings.

- **Delete single schedule**
 1. Click the delete icon  to the right of the schedule you want to delete.
 2. Click **Apply** in the upper right corner of the interface.
- **Delete all schedules**
 1. Click the delete icon  in the upper right corner of the interface.
 2. Click **Apply** in the upper right corner of the interface.

At this point, all schedules of programs and commands are deleted successfully, and the terminal does not execute the schedules.

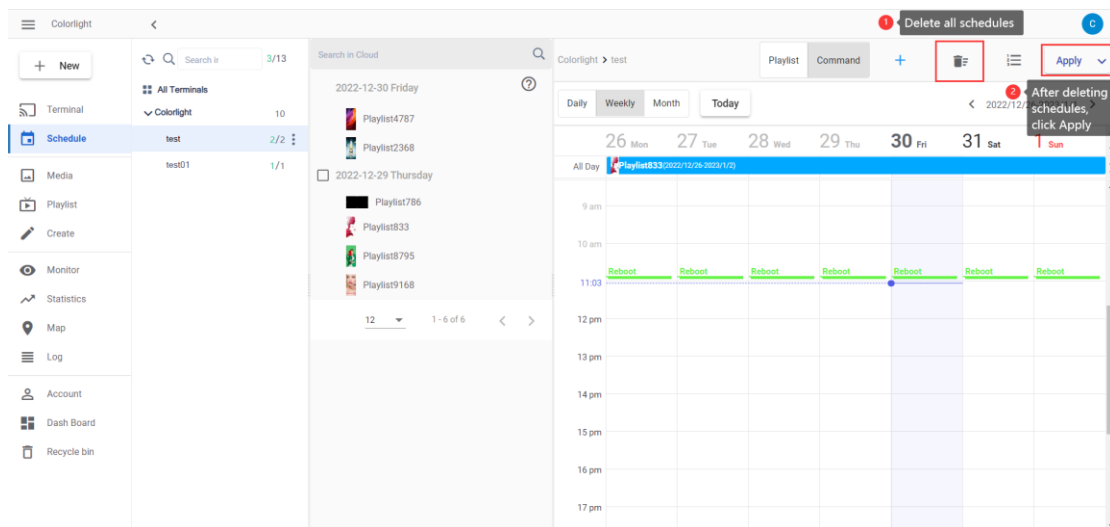

Figure 3-4 Delete Schedule

4 Manage media

In the "Media " module, you can manage the medias uploaded from the software and web side.

4.1 Upload media

You can upload media in 3 ways: drag & drop media from your computer, upload image or folder.

- **Upload media requirements**
 - Supported image formats for upload: jpeg, bmp, png, gif.
 - Supported video formats: mp4, avi, mpeg, mov, wmv.
 - The limit for a single image is: size not more than 20M. If the width or height of the image exceeds 8192, ColorlightCloud will automatically compress the widest or highest isometric to 8192.
 - The limit for a single video is: the size does not exceed 2G.
 - Only the super administrator can upload the upgrade package, the ordinary administrator cannot upload the upgrade package.
- **Drag and Drop Upload**

Drag and drop images or videos from local folders to the "My media" or "Upload" interface.

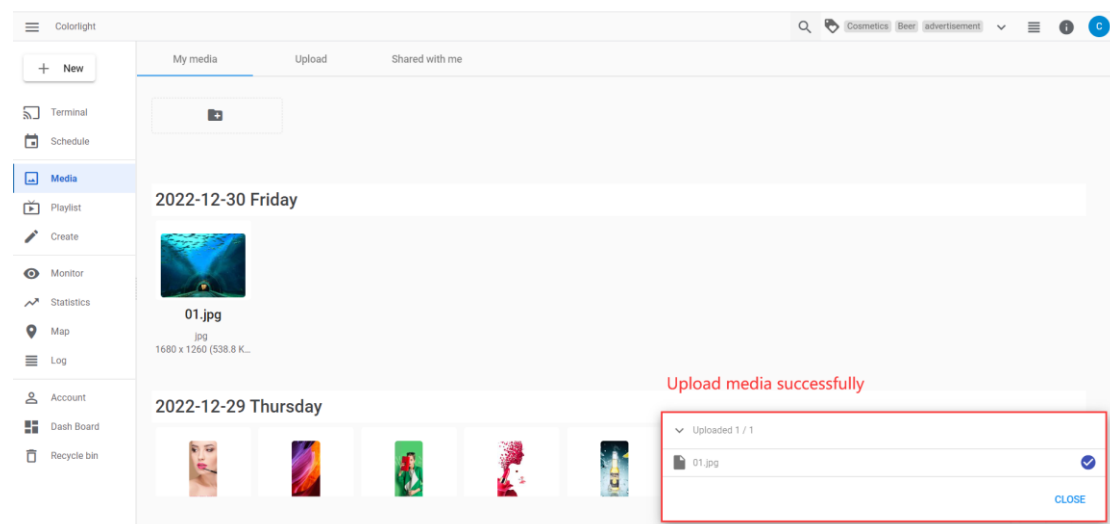

Figure 4-1 Upload media successfully interface

- **Upload image**
 1. Click **Upload** on the Upload interface.
 2. In the pop-up file window, select the image or video you want to upload and click **Open**.

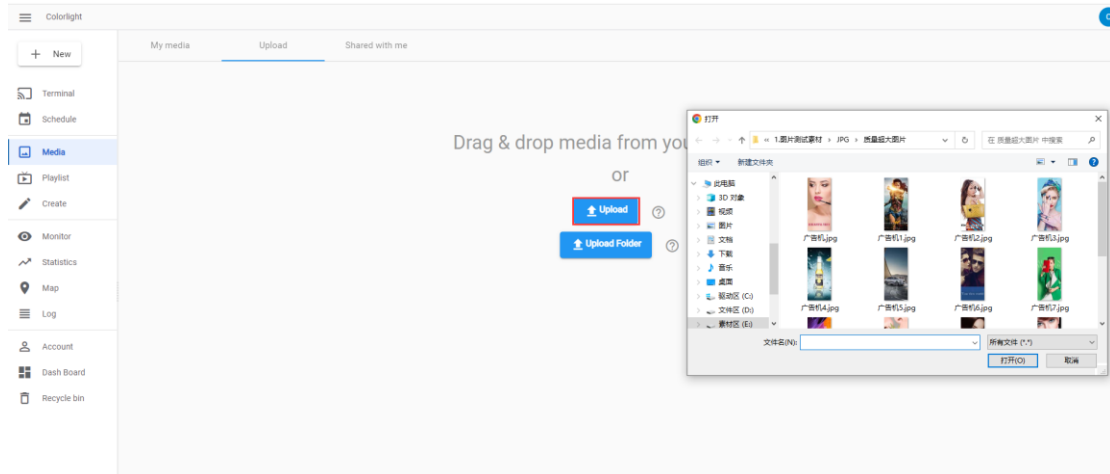



Figure 4-2 Uploading media interface

- **Upload folder**
 1. Click **Upload Folder** on the Upload interface.
 2. In the pop-up file window, select folder to upload.
 - Media in the folder must meet the "Upload media requirements " mentioned in the previous section. If there are media in the uploaded folder that do not meet the requirements, the upload will fail and you will need to remove the media that do not meet the requirements and upload again.

After upload successfully, you can see the newly uploaded media in the "My media" interface.

4.2 Delete media

If media have been referenced by a program, it cannot be deleted. You need to delete the program that referenced the media before you can delete the media. There are two ways to delete media.

- Select the media you want to delete and click the delete icon  at the top right of the interface.
- Select the media you want to delete and click the details icon  at the top right of the interface to view the details of the media. If there are no related programs referenced by the media, click **Delete**.

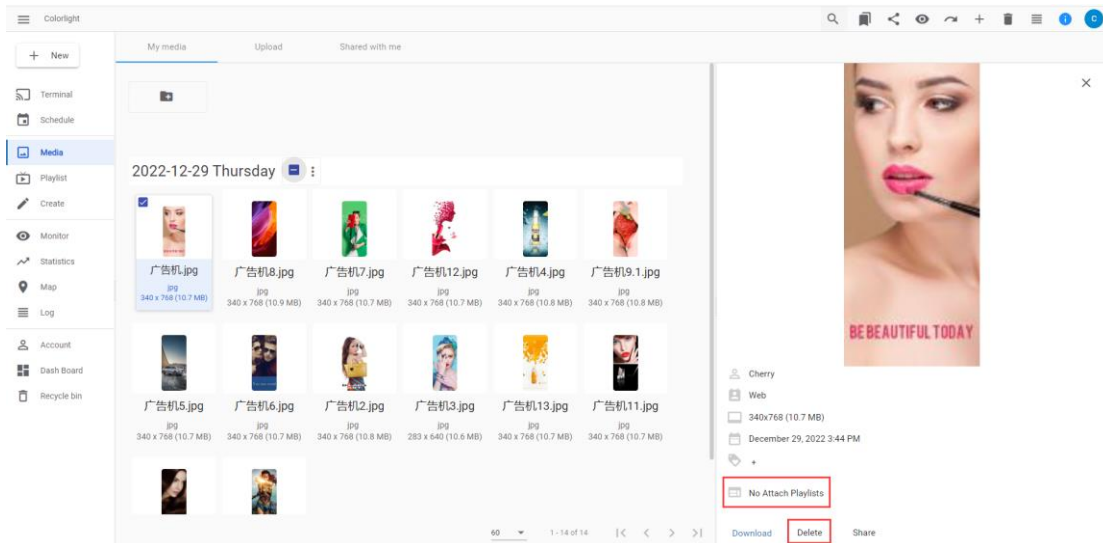



Figure 4-3 Delete media interface

4.3 Add Tag

Adding tags to media helps you manage more easily. There are 2 ways to add tags to media:

- Adding tags to single media**
 Select a media, click on  in the upper right corner of the interface or click on "+" in the media's details interface to add a tag.
- After entering a tag name, press the Enter key to enter multiple tags in succession, or check an existing tag to add a tag to media.
- Add tags to multiple media**
 If you select multiple media at the same time, the method of adding tags is the same as adding tags to 1 media.

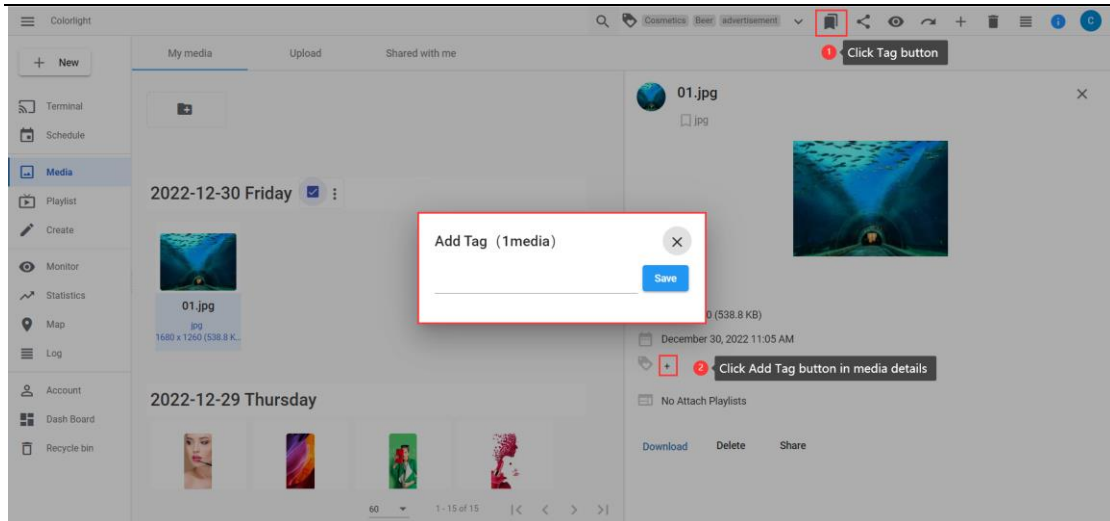

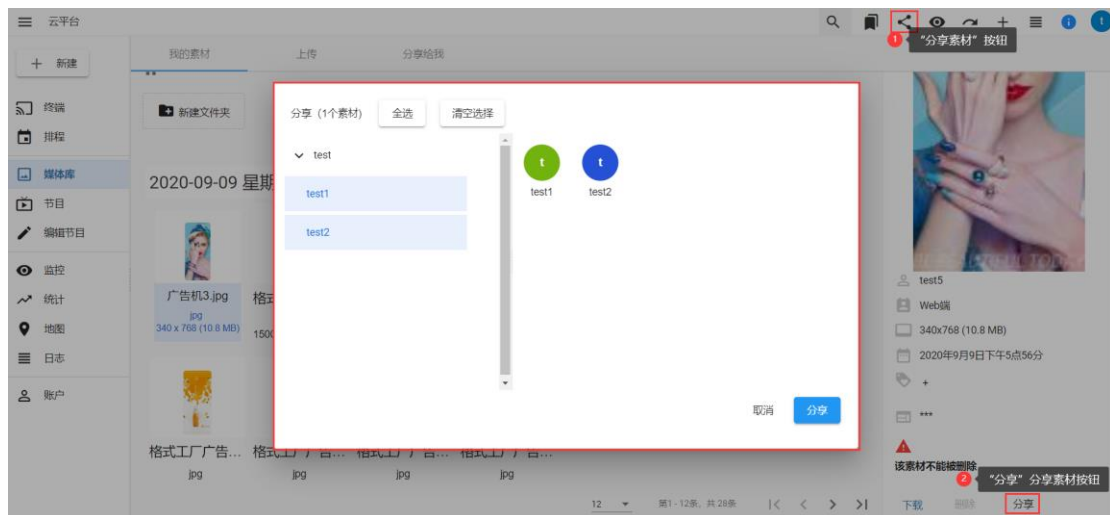

Figure 4-4 Adding Tag interface

4.4 Share

1. Select media, click the share icon  in the upper right corner of the interface, or click **Share** at the bottom of the View Media Details page.
2. In the pop-up window, select the terminal group and click **Share**.
 - Only higher-level users can share media to lower-level users.
 - You can share media to multiple subordinate users at the same time.
 - You can share 1 media or multiple media at the same time.



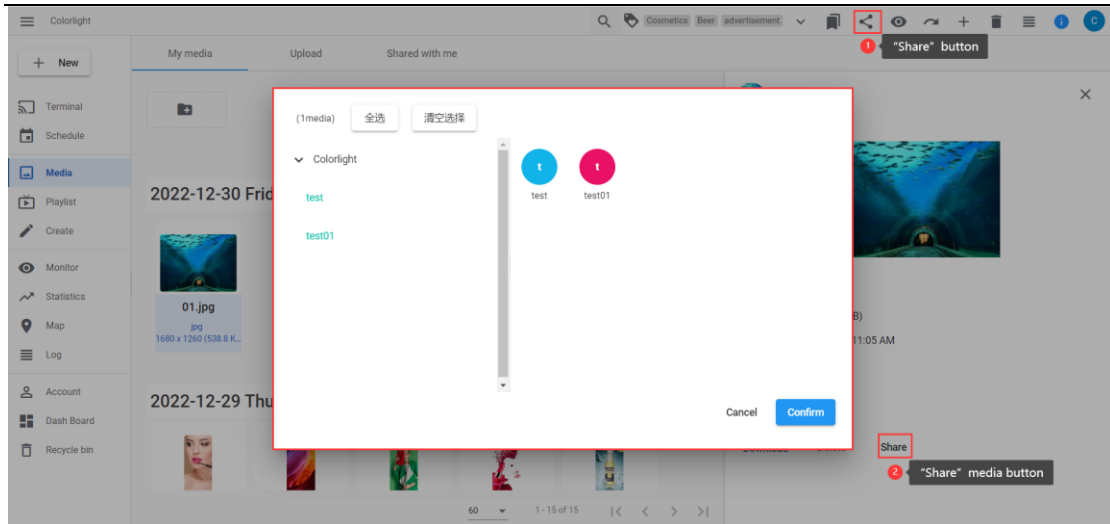

Figure 4-5 Share media interface

You can view the media shared to this account by the higher-level user in the "Shared with me". Use these media to create programs, but you cannot delete them.

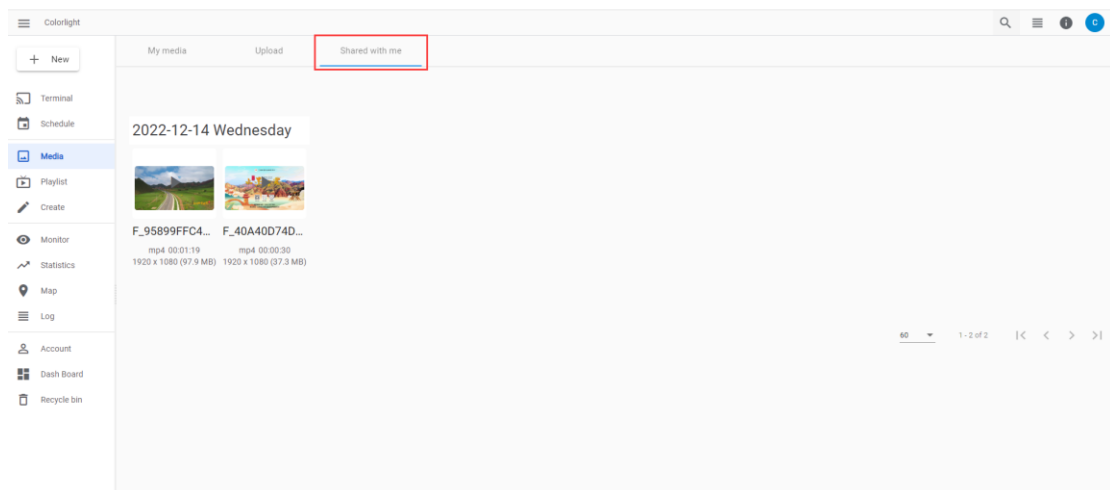



Figure 4-6 Shared with me interface

4.5 Preview media

Select media and click the preview icon  in the upper right corner of the interface.

- In the preview interface, you can rotate and zoom to view media, or click the download icon in the upper-right corner.

4.6 Create File Playlist

Select media and click the  in the upper right corner of the interface to

jump to the edit program page, you can use the media to create a program.

4.7 View media details

Select media and click the detail icon  in the upper right corner of the interface.

Media details will be displayed on the right side of the interface, you can view the media's upload user, source, size, upload date, tags, related programs and other information.

- You can Download, Delete and Share media on the media details page, but media that have been referenced by related programs cannot be deleted.

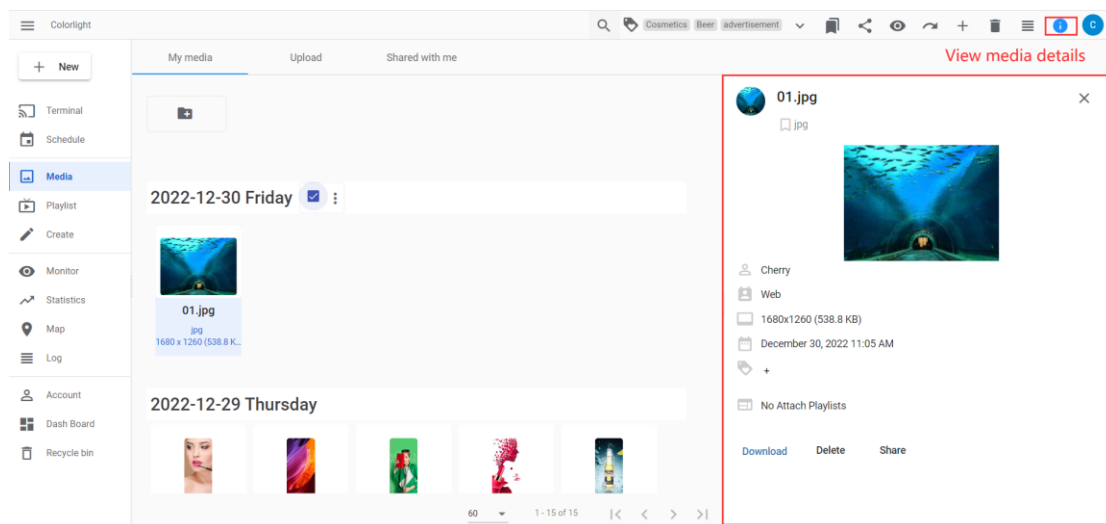



Figure 4-6 Media details interface

4.8 Search media

You can search for media through media name, criteria or tag, and you can use these search methods in combination to search for the desired media.

- Search by media name**

Click the search icon  at the top right of the interface, enter media name in the search box, and the media list will automatically display the search results.

- It supports media fuzzy search and precise search.

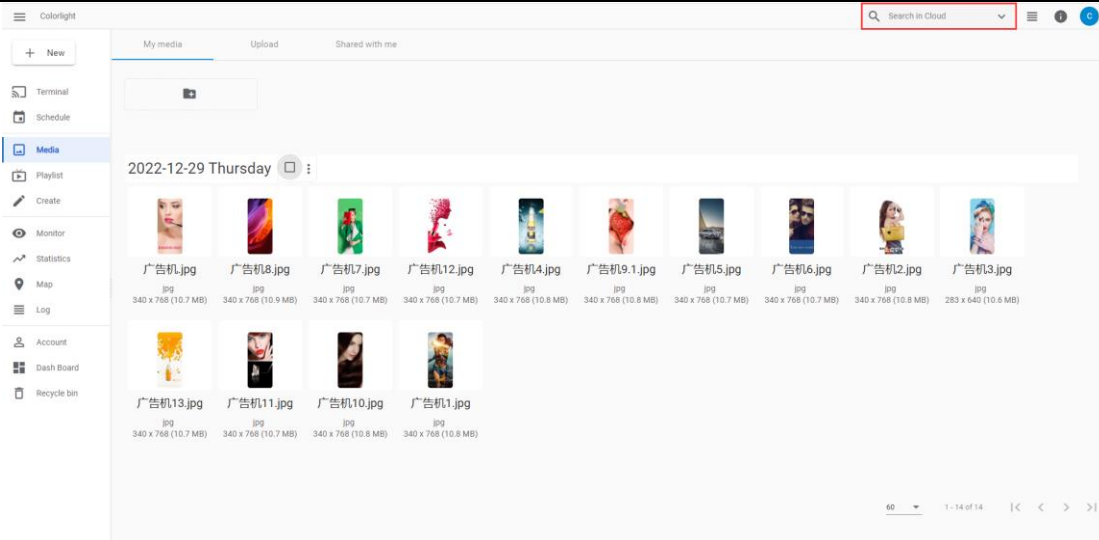



Figure 4-7 Search by media name interface

- **Search by criteria**

Click the drop-down icon  on the right side of the search box and select the media type, upload time, author, and source to search, each condition can be combined to search.

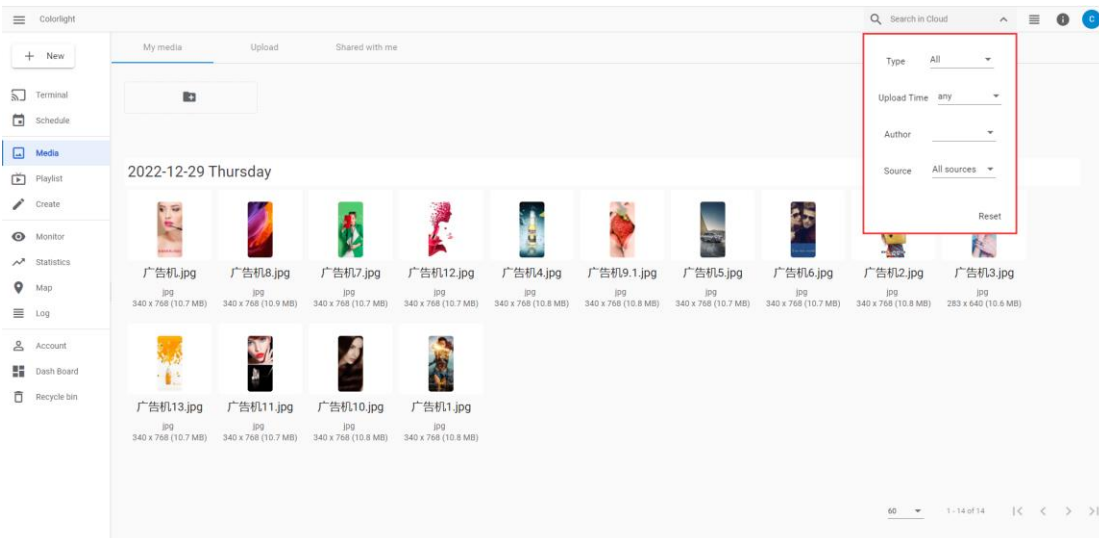

Figure 4-8 Search by criteria interface

- **Search by tags**

If you have added tags to some media, click the tag in the upper right corner of the interface to search for media with that tag, or you can check multiple tags at the same time to search for media.

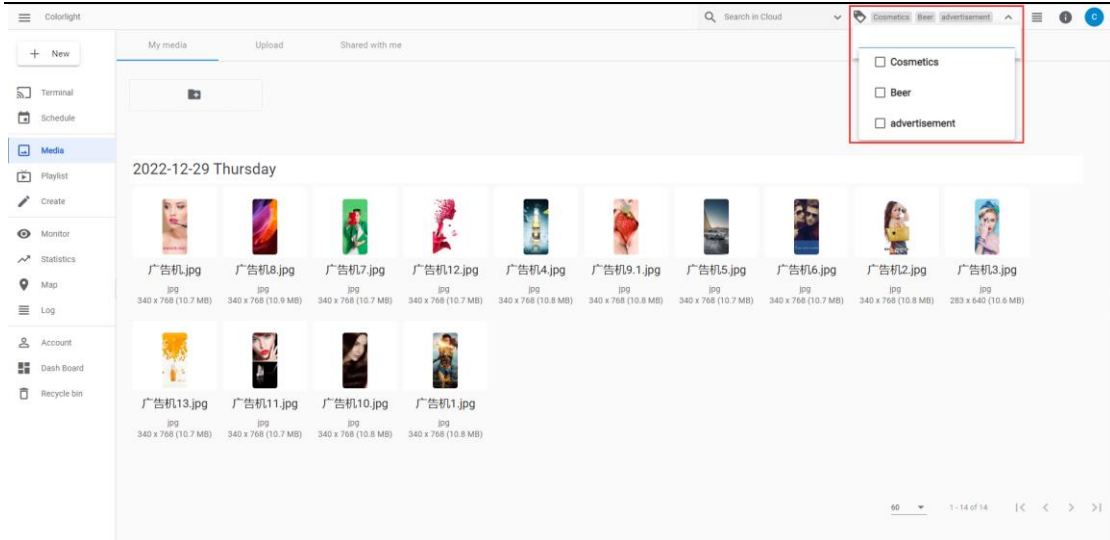



Figure 4-9 Search by tags interface

4.9 Manage media folders

The media uploaded from the software side and website will be uploaded to the root folder of the media library by default, you can create media folder to manage numerous media by category.

1. Click **Add Folder**, enter the folder name, and click **Create**.
2. Select one or multiple media and click the move icon  at the top right of the interface.
3. In the pop-up window, select the target folder and click **Move To Folder**. You can also Rename, Delete and Move to other folders.

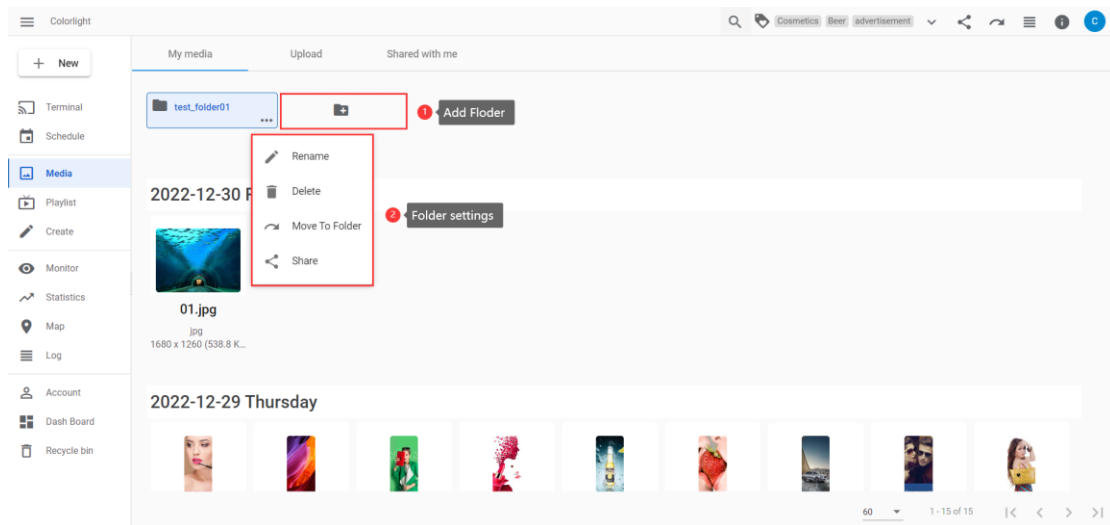

Figure 4-10 Manage media folders operation

5 Manage Program

In the "Programs" module, you can view all programs, common programs, template programs, programs to be reviewed, programs rejected by review and programs approved by review, search for programs, create program schedules, preview, publish, update and delete programs, view program details and check program.

5.1 Search Program

1. Enter a program name in the search field at the top right of the program module.
2. Click the search icon or press the Enter key to search for all programs containing the entered program name.

5.2 Create Program Schedule

1. Select the program and click the schedule icon  at the top right of the interface.
2. Jumps to the schedule module to create a program schedule by using program.

5.3 Preview Program

Select the program and click the preview icon  at the top right of the interface to pop up the program play effect.

5.4 Publish Program

1. Select a normal program or an approved program, and click the publish icon  at the top right of the interface.
2. In the pop-up publishing window, select the terminal group and terminal to be published, and click **Confirm**.

After the program is successfully published, the interface bottom will indicate "Publish successfully".

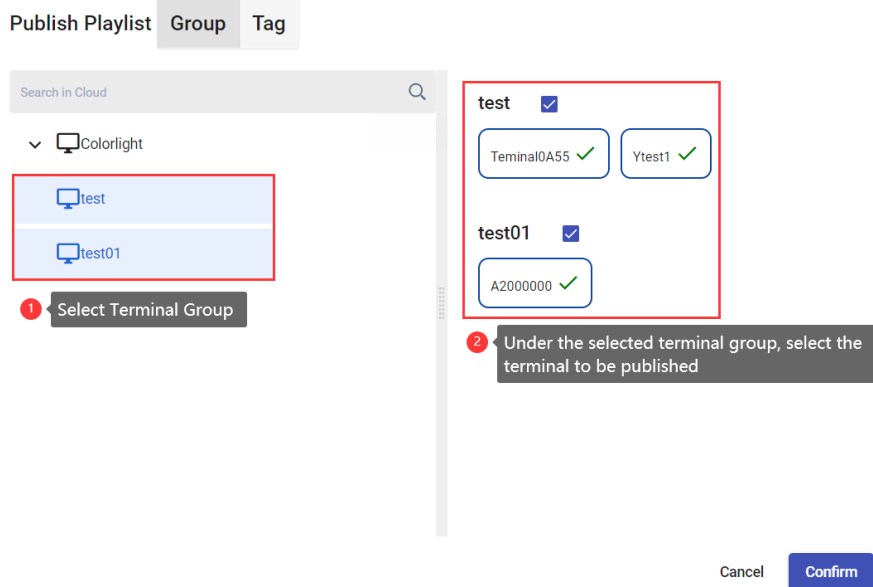



Figure 5-1 Publishing program window

5.5 Update Program

1. Select a program, click the edit icon  at the top right of the interface, or double-click the program.
2. Interface jumps to the schedule module to edit program.
3. After finishing editing, click **Apply** in the upper right corner of the interface.

If a program has already been published, after editing and saving, the program will be automatically updated to the terminal where it was previously published.

5.6 Delete Program

1. Select a single program or multiple programs (check the program production date to select multiple programs at the same time).
2. Click the delete icon  in the upper right corner of the interface and click **OK**.

After deleting successfully, it will appear "Deleted successfully" at the bottom of the interface.

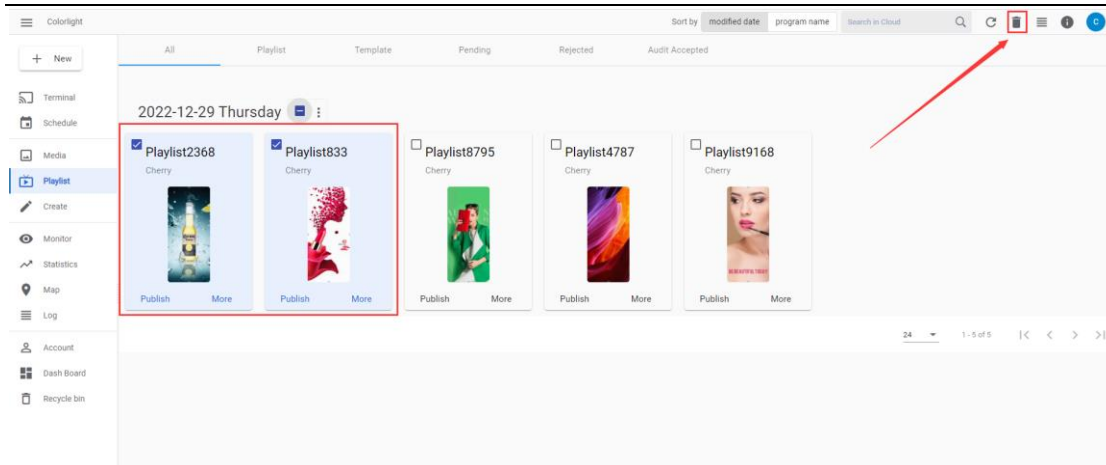





Figure 5-2 Deleting program interface

5.7 View program details

Select a program, click details icon  at the top right of the interface. The program details will be displayed on the right side of the interface, you can view the creation time, modified time, author, program type, published group, referenced material, and published to the terminal of the program.

5.8 Review Programs

Programs created by programmers need to be reviewed and approved by the administrator before they can be posted to the terminal.

1. Click **Pending review**.
2. Select a program and click the icon  to approve it, or click the icon  to reject it.

You can view the approved programs in "Approved" interface and the unapproved programs in "Rejected" interface.

6 Create Programs

In the "Create" module, you can create different types of programs.

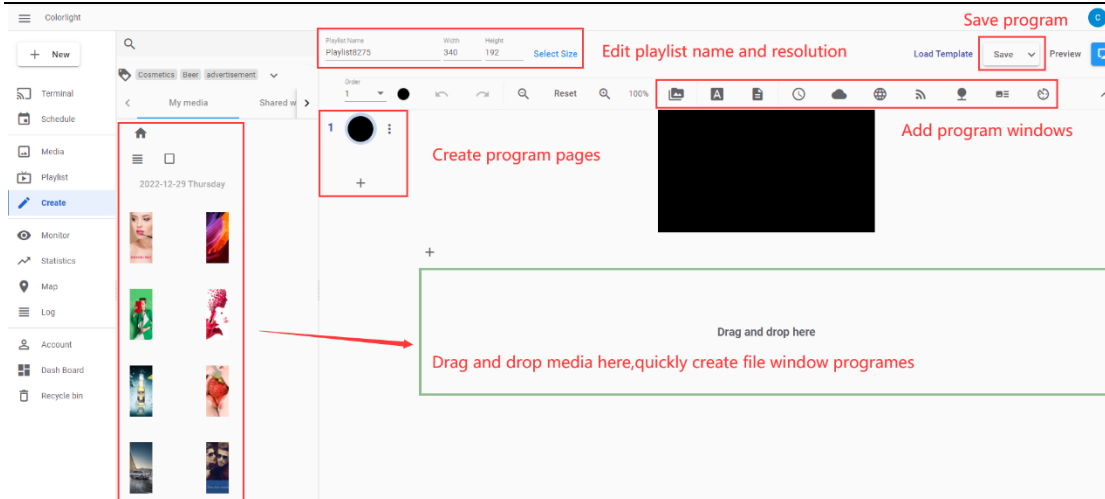

Figure 6-1 Create Program interface

6.1 Edit Playlist Name

You can edit the playlist name in the playlist name input field in the upper left corner of the interface.

- Playlist name input rules:
 - Playlist name input length limit: 2-64 characters.
 - Special characters supported by playlist name: space, underscore.

6.2 Edit Playlist Width and Height

The playlist resolution can be edited on the right side of the playlist name input field at the top of the interface.

- The first time you login ColorlightCloud, the default program resolution is 512×256.
- If you have modified the resolution, the server will record your user preference, and the default resolution of subsequent new programs will be the resolution entered last time.
- Maximum program resolution supported: 8192×4096.

6.3 Edit Playlist windows

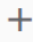
1. To add program window, click the playlist window icon at the top of the interface or click the add icon  at the bottom left of the playlist preview window.
2. As needed, add media and adjust the position and size of the program window.







The program window types are listed as follows:

Playlist window types	Description
Files	Display images, video files.
Single Line Text	Single-line display text content, supporting 1-512 characters.
Multi Line Text	Multi-line display text content, support 1-1000 characters.
Clock	Display the terminal time as a digital clock or an analog clock.
Weather	Display city weather information
Web	Display web page content (Program preview window cannot view the display effect, and the web page playback effect is subject to the actual display effect).
Rss	Display Rss content.
Environment	Display monitoring data for temperature, humidity, brightness, noise, smoke, air index.
Sync Play	After the programs produced by this window are published to multiple terminals, multiple terminals Sync Play effect can be realized.
Countdown	Display the time according to the set due date countdown.

Table 6-1 Playlist window types

6.4 Edit Playlsit Page

The program page displays the page content in thumbnail format, which enables the program to play each page of the program content sequentially like a PPT.

- Add program page: Click the add icon  at the bottom of the program page.
- Disable program page: Click the icon  on the right side of the program page and click the disable icon .
- Copy program page: Click the icon  to the right of the program page and click the copy icon .
- Delete program page: Click the icon  to the right of the program page and click the delete icon .

6.5 Preview Program

After editing a program, click **Preview** in the upper right corner of the interface to see how the program will play.

6.6 Save Program

After editing program, click **Save** in the upper right corner of the interface to save the program.

- Click the drop-down arrow next to **Save** to choose Publish, Save As or Save As Template.
- After loading template program, you can edit the program on the basis of the template.
- Template programs cannot be published to the terminal.
- Programs created by playlist editor are in pending review status by default, and you can view such programs in the pending review interview.

6.7 Load Templates

1. Click **Load Template**.
2. In the pop-up window, select the created template programs and click **Confirm**.

7 Monitor Terminal

In the "Monitor" module, you can view monitoring statistics and set alarms.

Steps:

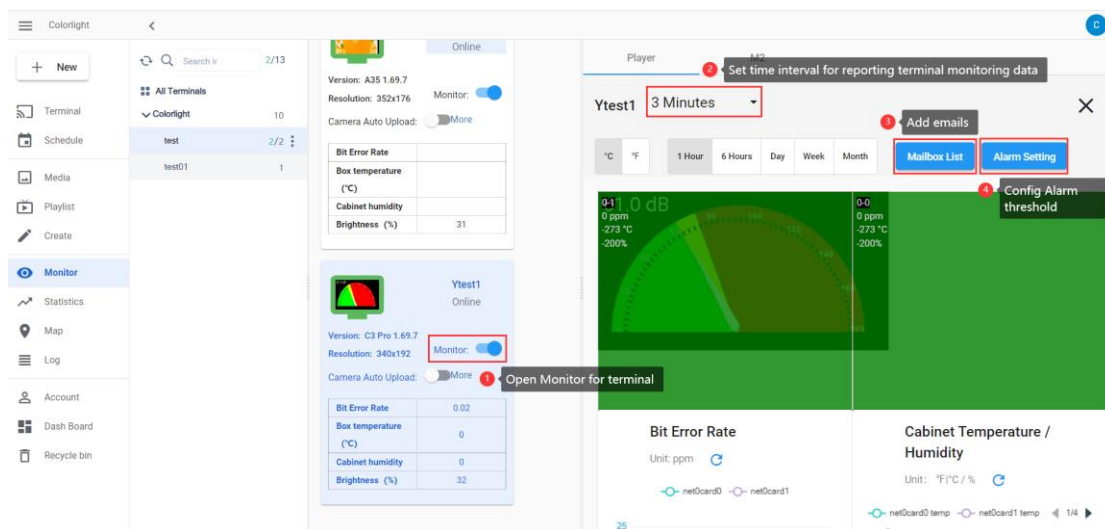

Figure 7-1 Monitor interface

1. Turn on terminal monitoring.
2. Select the terminal to be monitored, and set the monitoring data reporting interval on the right side of the terminal name at the top right of the interface.
 - Monitoring information in the Player Monitor interface:
 - Bit Error Rate: Bit Error Rate of the receiving card.
 - Box temperature and humidity: Terminal temperature and humidity.
 - Temperature: Ambient temperature.
 - Smoke: Ambient smoke.
 - Brightness: Ambient brightness.
 - Humidity: Ambient humidity.
 - PM10, PM2.5: Air quality.
 - Noise: Ambient noise.
 - Place mouse on the monitoring graph will show the specific data information.

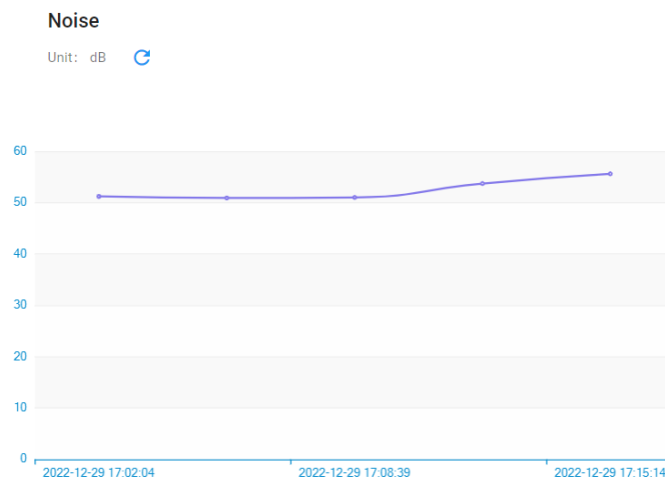

Figure 7-2 Monitor graph interface

3. Click **Mailbox List**, enter the email and click **Add**.
4. Click **Alarm Setting** to set the alarm threshold.
 - **Basic alarm for terminal:** Monitor whether the terminal is offline. When this alarm is enabled, server will send emails to remind users when the terminal is offline.
 - **Config card alarm:** Monitor the receiving card's Bit Error Rate of the screen connected to the terminal and its temperature and humidity. After enabling this alarm, server will send emails to remind the user when the real-time data

exceeds the set threshold.

- **Config environment alarm:** Monitor the external terminal environment, terminal's external probe requires to return environmental data. After enabling this alarm, server will send emails to remind the user when the real-time data exceeds the set threshold.
5. Optional: If the terminal is connected to M2, select M2 monitor interface and click **Auto Control Settings** to set the temperature threshold.
- When Auto Control Settings is enabled, the relay will automatically close or open when the onboard temperature or sensor temperature is greater than the set threshold.

Auto Control Settings

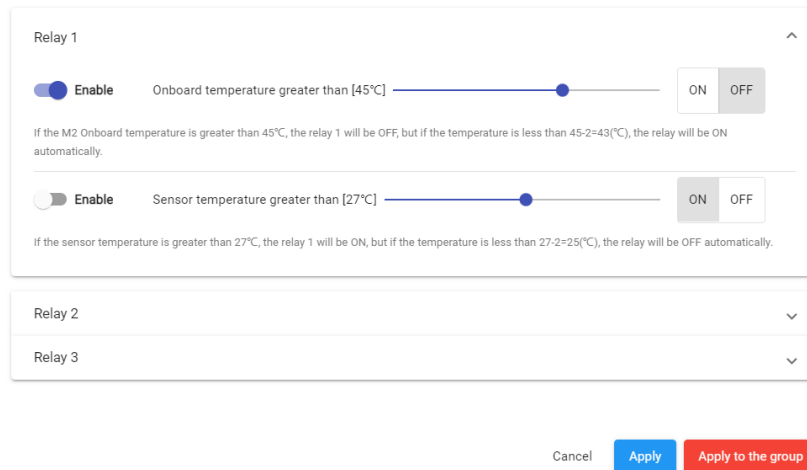

Relay 1

Enable Onboard temperature greater than [45°C] ON OFF

If the M2 Onboard temperature is greater than 45°C, the relay 1 will be OFF, but if the temperature is less than 45-2=43(°C), the relay will be ON automatically.

Enable Sensor temperature greater than [27°C] ON OFF

If the sensor temperature is greater than 27°C, the relay 1 will be ON, but if the temperature is less than 27-2=25(°C), the relay will be OFF automatically.

Relay 2

Relay 3

Cancel Apply Apply to the group

Figure 7-3 Auto Control Settings

- Monitoring information in the M2 monitor interface.
 - Temperature: Ambient temperature.
 - Smoke: Ambient smoke.
 - Brightness: Ambient brightness.
 - Humidity: Ambient humidity.
 - Voltage: External voltage.
 - Electromagnetic: The opening and closing status of electromagnetic door.
 - PM10, PM2.5: Air quality.
 - Onboard temperature: M2 Temperature.
 - Onboard humidity: M2 Humidity.
 - Relay Status: The closing and breaking state of the relay on M2.
 - Noise: Ambient noise.

8 View terminal statistics

In "Statistics" module, you can view the terminal has played the media times, terminal online / offline time and switching times.

8.1 View media playing times

Click **Statistics**, select terminal, on the interface right side, you can view the terminal has played each media times.

- The number of times a device plays a media can be counted only when impressions is enabled.
- Click the time range on the interface right side to modify the time range to view the statistics in different periods.
- Click the download icon  to export the statistics to an excel sheet.

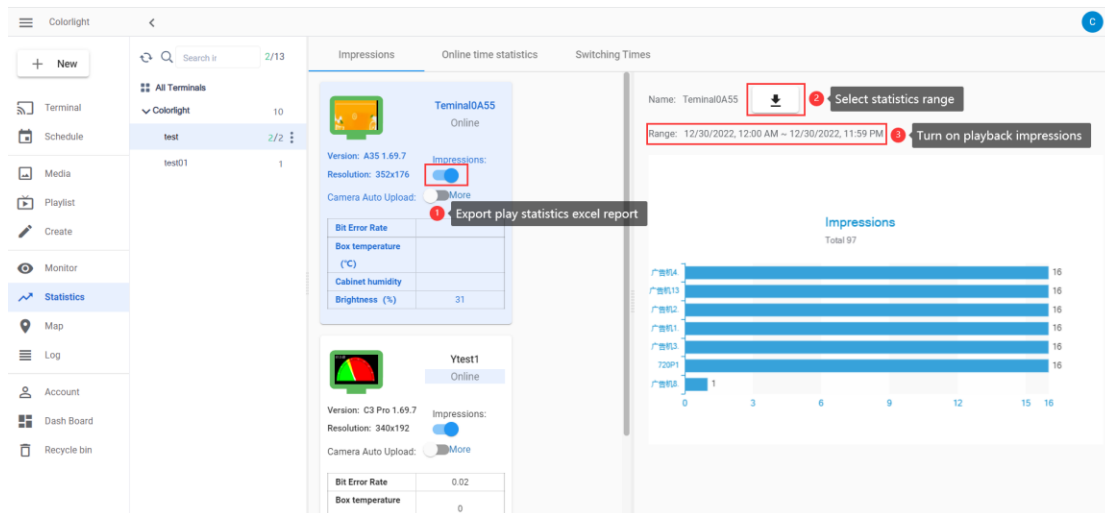



Figure 8-1 Playback statistics interface

8.2 View online time

Click **Online time statistics** to view the Device ID, SIM Card ID, Device name, Terminal Description, Accumulated online time, Accumulated offline time and Current status of all terminal devices.

- Select a terminal group in the terminal tree on the left to view terminals online time statistics in the terminal group.
- Modify time range at the interface top to view the statistics in different time periods.
- Click the export icon  to export the statistics to an excel sheet.
- Place cursor on the terminal name to view the terminal online / offline statistics histogram.

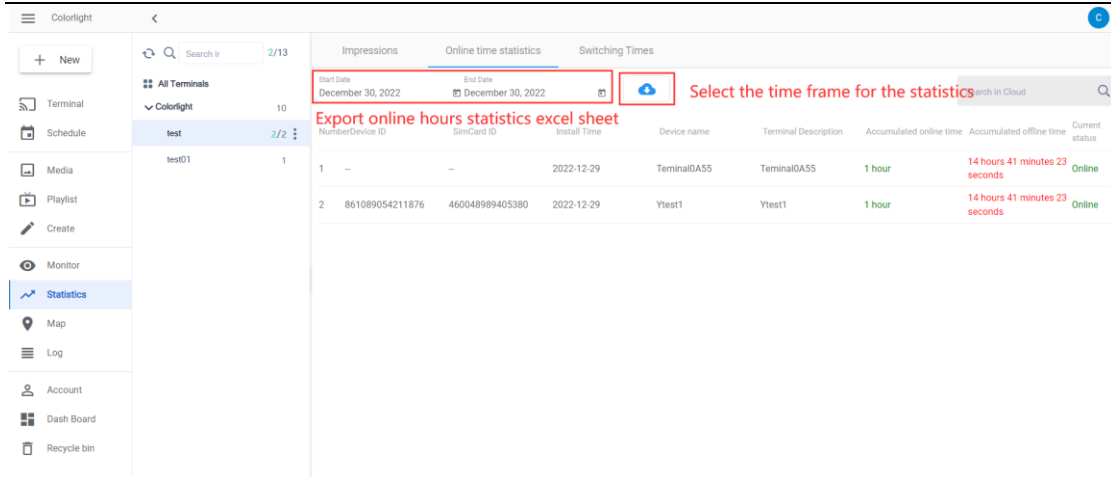

Figure 8-2 Online time statistics interface

8.3 View Switching Times

Click **Switching Times** to view the switching times of all terminal devices.

- Modify the time range at the interface top to view the statistics in different periods.

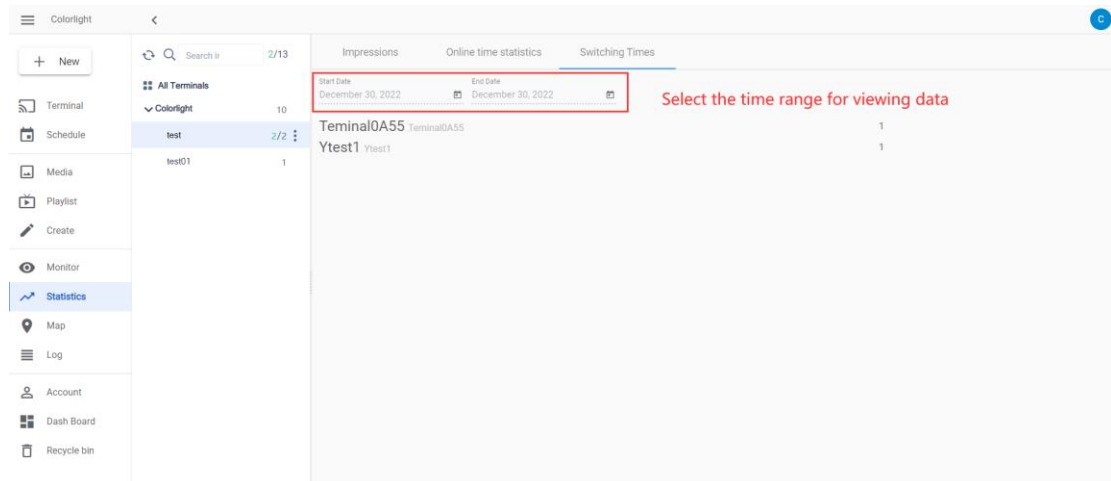



Figure 8-3 Switching time statistics interface

9 View terminal map

In "Map" module, you can view terminal coordinates, terminal traces and heat maps. To apply the map module functions, the terminal needs to meet the following conditions:

- The terminal has a built-in 4G module and an external GPS antenna.
- The terminal can report GPS data to the server normally.

9.1 View terminal coordinates

1. Click any location on the map and click the icon  in the pop-up window below the map.

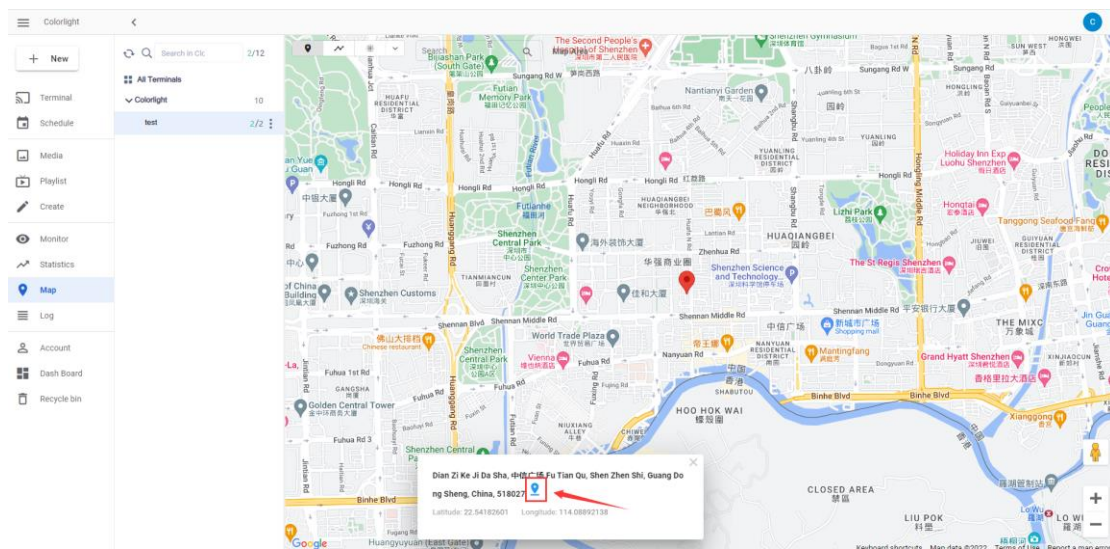



Figure 9-1 Add coordinates interface

2. Select a terminal, add it to map.
 - The location icon is blue when the terminal is online and gray when it is offline.
3. Select the added terminal on the map and enable GPS data reporting.
4. Select the report interval and click **Apply**.

After adding the terminal coordinates manually, you can click the icon  at the top of the interface and check the **Auto refresh** checkbox to refresh the terminal's location automatically.

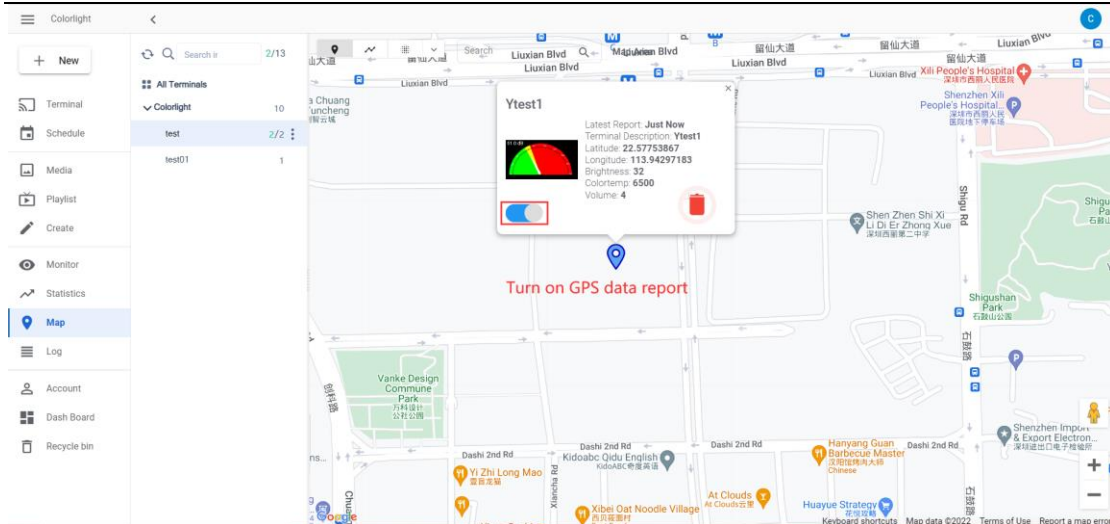



Figure 9-2 Enable GPS data report

9.2 View terminal traces

1. Click the track icon  at the interface top.
2. In the drop-down window, select the terminal track to view.

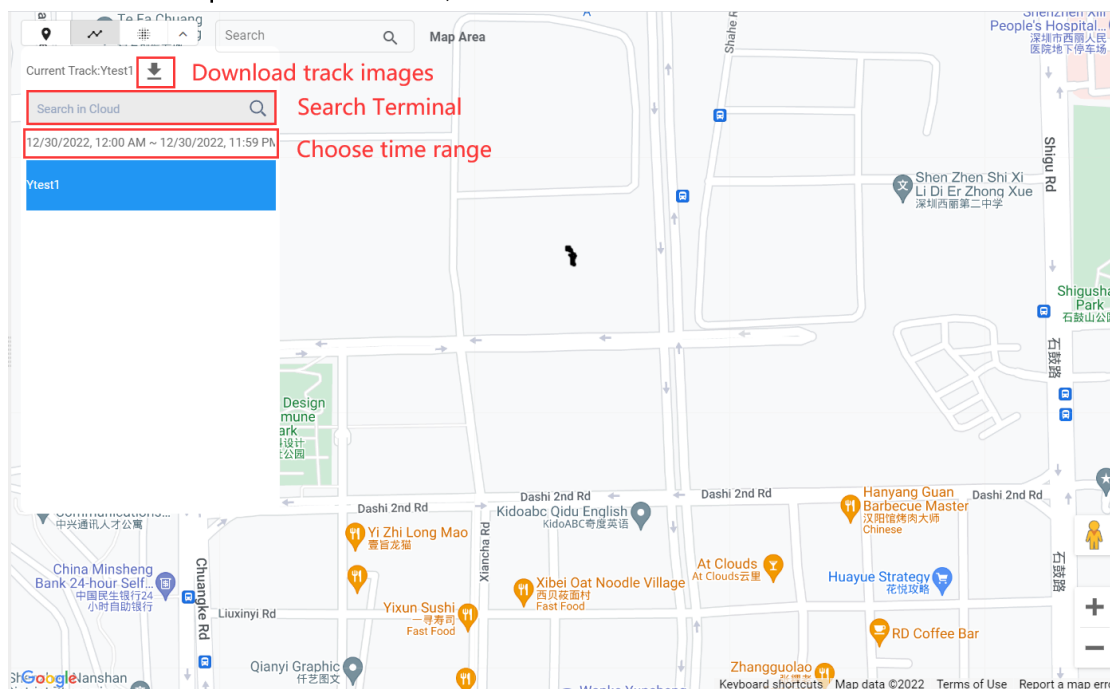



Figure 9-3 Terminal trajectory interface

9.3 View Heat map

Heat map shows GPS-enabled terminals density on the map. At the interface top, click the icon .

- Select time range to view the heat map in different time periods.
- Click the download icon  to export the heat map to local file.

10 View Operation log

In the "Log" module, you can view terminal operation log, terminal log and content management log.

10.1 View terminal operation log

Terminal operation log is a log of user operations on the terminal. You can view the operations of the current user and its subordinate users on the terminal.

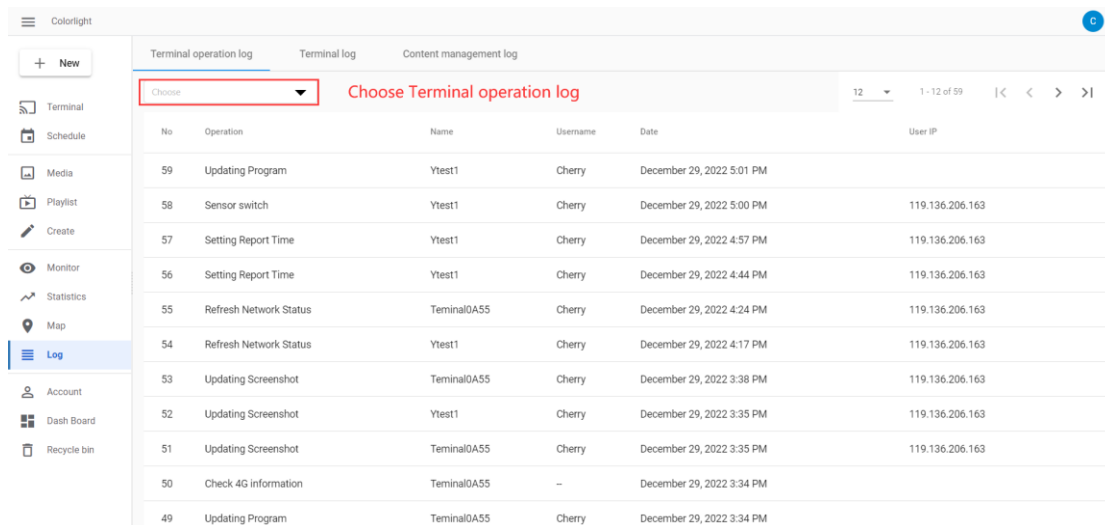

No	Operation	Name	Username	Date	User IP
59	Updating Program	Ytest1	Cherry	December 29, 2022 5:01 PM	
58	Sensor switch	Ytest1	Cherry	December 29, 2022 5:00 PM	119.136.206.163
57	Setting Report Time	Ytest1	Cherry	December 29, 2022 4:57 PM	119.136.206.163
56	Setting Report Time	Ytest1	Cherry	December 29, 2022 4:44 PM	119.136.206.163
55	Refresh Network Status	Terminal0A55	Cherry	December 29, 2022 4:24 PM	119.136.206.163
54	Refresh Network Status	Ytest1	Cherry	December 29, 2022 4:17 PM	119.136.206.163
53	Updating Screenshot	Terminal0A55	Cherry	December 29, 2022 3:38 PM	119.136.206.163
52	Updating Screenshot	Ytest1	Cherry	December 29, 2022 3:35 PM	119.136.206.163
51	Updating Screenshot	Terminal0A55	Cherry	December 29, 2022 3:35 PM	119.136.206.163
50	Check 4G information	Terminal0A55	-	December 29, 2022 3:34 PM	
49	Updating Program	Terminal0A55	Cherry	December 29, 2022 3:34 PM	

Figure 10-1 Terminal operation log interface

10.2 View terminal log

Terminal log records the terminal operating time and storage space.

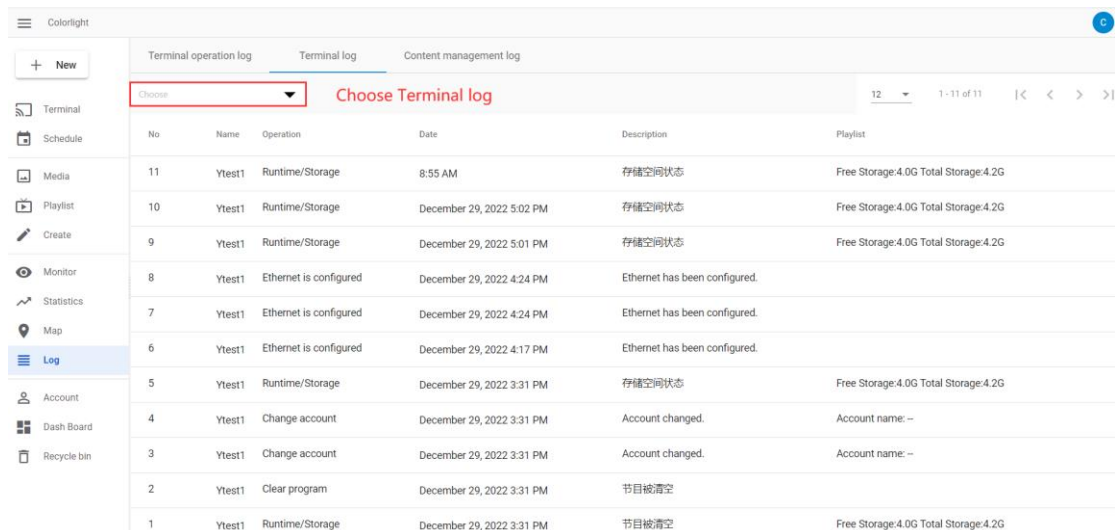

No	Name	Operation	Date	Description	Playlist
11	Ytest1	Runtime/Storage	8:55 AM	存储空间状态	Free Storage:4.0G Total Storage:4.2G
10	Ytest1	Runtime/Storage	December 29, 2022 5:02 PM	存储空间状态	Free Storage:4.0G Total Storage:4.2G
9	Ytest1	Runtime/Storage	December 29, 2022 5:01 PM	存储空间状态	Free Storage:4.0G Total Storage:4.2G
8	Ytest1	Ethernet is configured	December 29, 2022 4:24 PM	Ethernet has been configured.	
7	Ytest1	Ethernet is configured	December 29, 2022 4:24 PM	Ethernet has been configured.	
6	Ytest1	Ethernet is configured	December 29, 2022 4:17 PM	Ethernet has been configured.	
5	Ytest1	Runtime/Storage	December 29, 2022 3:31 PM	存储空间状态	Free Storage:4.0G Total Storage:4.2G
4	Ytest1	Change account	December 29, 2022 3:31 PM	Account changed.	Account name: --
3	Ytest1	Change account	December 29, 2022 3:31 PM	Account changed.	Account name: --
2	Ytest1	Clear program	December 29, 2022 3:31 PM	节目被清空	
1	Ytest1	Runtime/Storage	December 29, 2022 3:31 PM	节目被清空	Free Storage:4.0G Total Storage:4.2G

Figure 10-2 Terminal log interface

10.3 View content management log

Content management log records the operation contents of the current user and its subordinate users on some parts of ColorlightCloud server interface, mainly records the operation contents about terminals, schedule, media and programs.

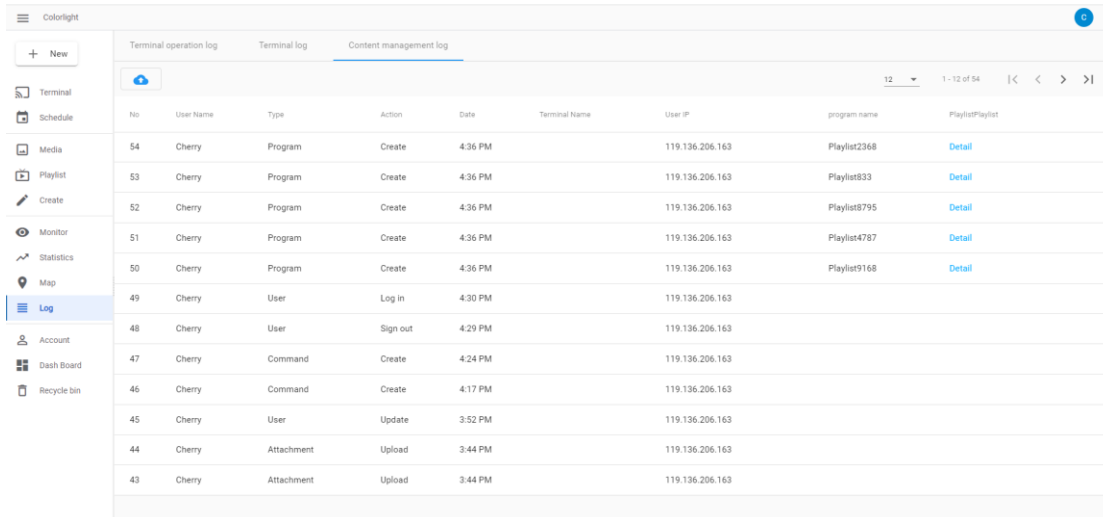

No	User Name	Type	Action	Date	Terminal Name	User IP	program name	Playlist/Playlist
54	Cherry	Program	Create	4:36 PM		119.136.206.163	Playlist22368	Detail
53	Cherry	Program	Create	4:36 PM		119.136.206.163	Playlist833	Detail
52	Cherry	Program	Create	4:36 PM		119.136.206.163	Playlist8795	Detail
51	Cherry	Program	Create	4:36 PM		119.136.206.163	Playlist4787	Detail
50	Cherry	Program	Create	4:36 PM		119.136.206.163	Playlist9168	Detail
49	Cherry	User	Log in	4:30 PM		119.136.206.163		
48	Cherry	User	Sign out	4:29 PM		119.136.206.163		
47	Cherry	Command	Create	4:24 PM		119.136.206.163		
46	Cherry	Command	Create	4:17 PM		119.136.206.163		
45	Cherry	User	Update	3:52 PM		119.136.206.163		
44	Cherry	Attachment	Upload	3:44 PM		119.136.206.163		
43	Cherry	Attachment	Upload	3:44 PM		119.136.206.163		

Figure 10-2 Content management log interface

11 Manage accounts

In the "Account" module, you can view the current account statistics, edit personal information, manage users, change system default settings and view system version.

11.1 View account statistics

In the "Dash Board" interface, you can view the current account statistics: Subsidiary users, Playlists number, Groups number, Total Space, Device Total, Today Accumulated online time (Hour), Today Total Mileage (km).

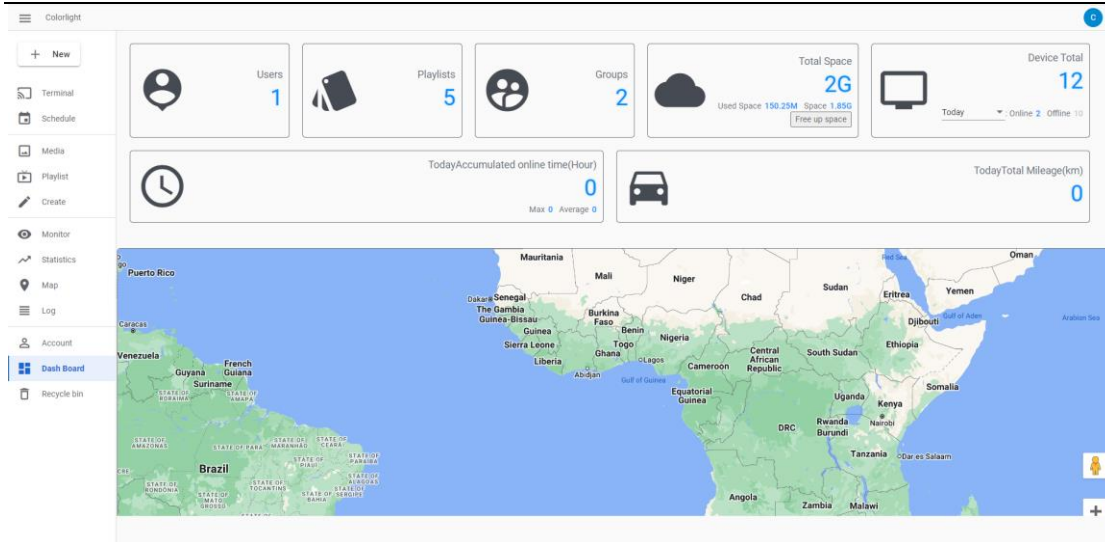

Figure 11-1 Dash Board interface

Statistics type	Description
Users	All users on this account.
Playlists	Programs number on this account.
Groups	Terminal groups number on this account, including root groups and sub-terminal groups.
Total Space	Total space on this account is mainly used to store programs and media.
Device Total	Devices total, online number shows the number of devices that have been running during the selected time period on this account.
Today Accumulated online time (Hour)	All terminals today total accumulated online time of on this account.
Today Total Mileage (km)	All terminals today total distance mileage on this account.

11.2 Reset Password

1. In the "Account info" interface, click **Reset Password**.
2. Enter your original password, then enter your new password, click **Confirm**.
 - New password must contain upper and lower case letters and be no less than 8 and exceed than 20 digits long.

11.3 Login Authentication

You can enable two-factor authentication to improve your account security.

1. Download the "Authenticator" application on phone.
2. In the "Account info", click **Turn on two-factor authentication**.
3. In the pop-up window, click **Re login**.
4. In ColorlightCloud login interface, enter your username and password, and then open the Authenticator app to scan the QR code to bind your phone.

After turning on two-factor authentication, you need to enter password and the dynamic code provided by Authenticator to login ColorlightCloud.

If you want to unbind your cell phone, you can click **Unbind Mobile Phone** in the "Account info" and then click **Confirm**.

11.4 Switch language and theme

In the "Account info" interface, you can switch ColorlightCloud interface language to English, Chinese, French, Russian or Ukrainian and switch the theme to default or dark theme.

11.5 Manage users

o In the "Subsidiary Account" interface, administrators can sign up or bulk delete users, allocate space for users, search for users, and turn on two-factor authentication, allow, forbid, switch impersonate, edit roles, reset passwords, and delete operations for subordinate users.

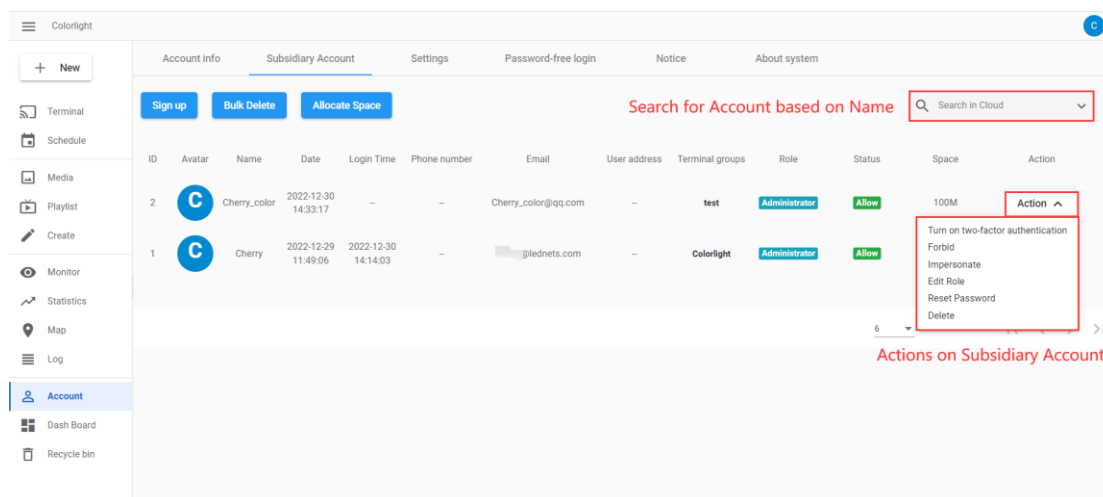

Figure11-2 Subsidiary Account interface

Operations for subordinate users:

Operation	Description
Turn on two-factor authentication	After enabling two-factor authentication, password and verification code provided by Authenticator are required to log in.
Allow	Allow the user's login to ColorlightCloud.
Forbid	Forbid the user to login ColorlightCloud.
Impersonate	Switch the current account to the user's role.
Edit roles	Change the user's role.
Reset passwords	Reset the user's login password.
Delete	Delete the user. You can completely delete or restore the user in the Recycle Bin.

Each role authority are as follows:

Role	Authority
Administrator	Has full permissions, can manage all modules, manage subordinate users, and create all roles.
Operator	Except for the permissions to delete terminals, create and delete roles, and manage users, the rest of the permissions are the same as those of administrators.
Playlist Editor	Create new programs, preview programs, edit programs pending review and review rejected programs.
Invitee	View the terminal group and terminal details, upload media, and create folders.
Auditor	Review programs, preview programs
Monitor	Preview programs, view logs, view terminals and share media.
Advertiser	View playing ads.

Table 11-1 Role authorities

11.6 System Settings

In the "System Settings" interface, you can modify ColorlightCloud default display functions.

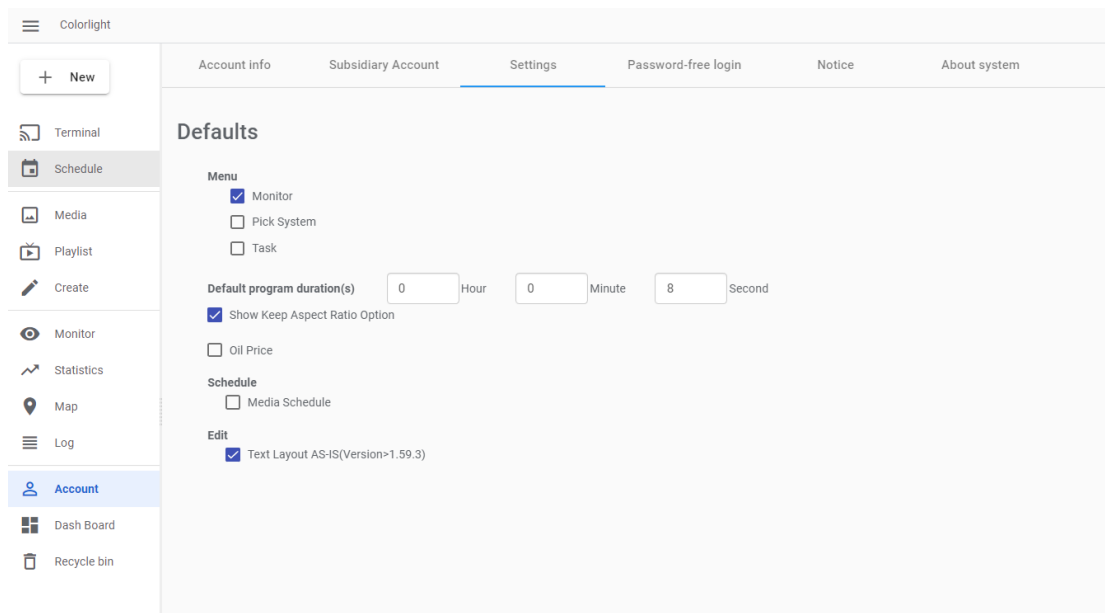

Figure 11-3 Defaults settings

- Menu**
 You can check or uncheck the checkboxes of **Monitor**, **Bucket Program**, **Regional Task**, and **Make Video** to show or hide the corresponding

function modules.

- **File**

You can set the default playback duration of picture media. You can constrain the ratio of the file window media when editing the show by checking the program **Keep Ratio** button checkbox.

- **Oil Price**

When this checkbox is checked, the program type of the edited program includes the Oil Price window.

- **Schedule**

When the **Media Schedule** checkbox is checked, you can set the schedule of the file window media when editing a program, so that the specified media will be played at the specified time.

- **Edit**

After checking the check box of **Consistent text layout and web page editing**, the playback effect of the created text program after publishing to the terminal is consistent with the effect displayed on the web page.

11.7 View ColorlightCloud version

In the "About System", you can check the software version and ColorlightCloud server version.

Statement

Copyright © 2023 Colorlight Cloud Tech Ltd. . All rights reserved.

Without the express written permission of Colorlight Cloud Tech Ltd., no unit or individual may copy, copy, transcribe or translate part or all of the contents of this book. Not to be used for any commercial or profit-making purposes in any form or by any means.

This guide is for reference only and does not constitute a promise of any kind. Please refer to the actual products (including but not limited to colour, size, screen display, etc.).

Service Phone

4008 770 775

Colorlight Cloud Tech Ltd.

Official Website: www.colorlightinside.com
Head Office Address: Room 37F-39F, Building 8, Zone A,
Shenzhen International Innovation Valley, Vanke Cloud City, Dashi Yilu,
Nanshan District, Shenzhen, China

